

PRESRV™

REFRIGERATOR
DRAWERS

DUAL ZONE



From snacks for the kids to the freshest produce to party-ready food and drinks, these stylish under-counter Panel Ready Dual Zone Refrigerator Drawers beautifully harmonize with your cabinetry and give you additional cold storage right where you need it. This large capacity refrigerator

maintains two distinct temperature zones and is loaded with features like Quick Chill to instantly lower overall refrigerator temperature; handy temperature presets; full-extension, soft-close drawers and the ability to blend into your kitchen cabinetry seamlessly.

ZEPHYR

ZEPHYRONLINE.COM



Quick Chill



Shown with overlay panel and custom handle (not included)

How Presrv™ Stands Out:



PreciseTemp™

Multiple internal sensors help maintain accurate temperatures



Drawer Organizers

Customizable drawer organizers help keep everything in its place



Active Cooling Technology

An on-board computer controls active cooling fans to provide temperature stability and even cooling



Soft-Close Drawers

Close more smoothly and quietly to prevent shifting of drawer contents

Overlay Panel Dimensions*

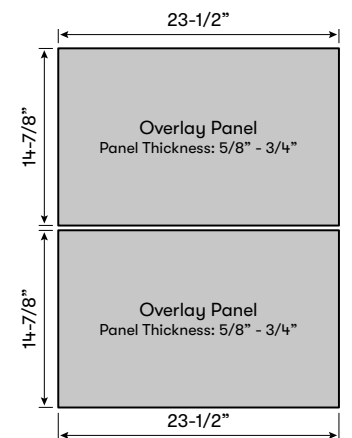

*panel not included

MODEL

Dual Zone
Refrigerator Drawers **PRRD24C2AP**

Size 24"
Dimensions 23-7/8"W x 33-7/8"H x 24"D
Weight 121 lbs.
Installation Type Compact / Built-in
Refrigerant Type R600a

FEATURES

Volume 5.1 cu/ft
Temperature Range 33° - 65° F (each zone)
Sound Level 38 dBA
Exterior Drawer Finish Panel-Ready, no handle
Interior Drawer Finish Stainless Steel
Exterior Cabinet Finish Black
Interior Cabinet Finish Black
Full-Extension Drawers Yes
Soft-Close Drawers Yes
Removable Silicone Drawer Mat Yes
Drawer Organization Adjustable Bar Dividers +
Transparent Drawer Tray

Lighting 3-Color LED Lighting
Cloud White, Deep Blue, Amber

Controls 3-Color Electronic Touch
Preset Temperature Modes Produce, Beverage, Wine
Quick Chill Yes, for faster cooldown
Door Open Alarm Yes
Dual Evaporators Yes
Sabbath Mode Yes
ENERGY STAR® Certified Yes
PreciseTemp™ Yes
Active Cooling Technology Yes

AC POWER 115V, 60Hz at Max. 1.5A

OPTIONAL ACCESSORIES

Contemporary Handle* PRHAN-C101 (Stainless Steel)
Contemporary Handle* PRHAN-C102 (Brushed Gold)
Contemporary Handle* PRHAN-C104 (Matte Black)
Pro Handle Kit PRHAN-C002 (Stainless Steel, 2 per kit)

WARRANTY 2 years parts, 2 years labor
5 years compressor

*1 handle included, 2 handles required.

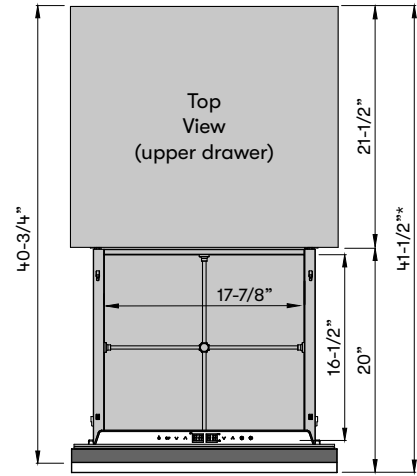

*Depth with 3/4" thick overlay panel

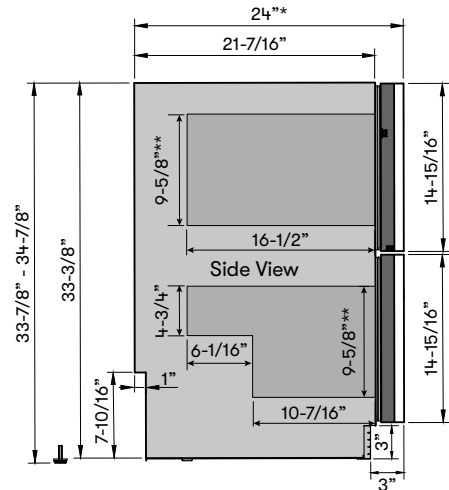

*Depth with 3/4" thick overlay panel
** Maximum clearance height inside drawers is 12"

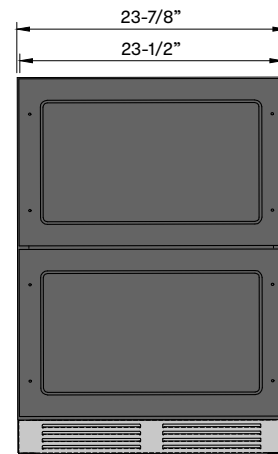

Transforming the Kitchen through Design, Discovery, and Care

Specifications subject to change, check zephyronline.com for up-to-date information.
Zephyr | 2277 Harbor Bay Parkway, Alameda, CA 94502 | 888.880.8368

