

## Quick Setup

**IMPORTANT:** Before using this product, make sure you read these instructions and the safety instructions in the online *User's Guide*.

**Note:** Your product may differ from the illustrations on this sheet, but the instructions are the same.

## Choose a location

Keep the projector level and place it at a height so its lens is even with the top or bottom of the screen and is centered horizontally. If this isn't possible, use the lens shift feature to reposition the image (see "Adjust the image").

See the online *User's Guide* for more information on where to place your projector.

## Connect the projector

Connect multiple video devices and use the **Source** buttons on the remote control or the **Source** button on the projector to switch between them. For additional connection types, see the online *User's Guide*.

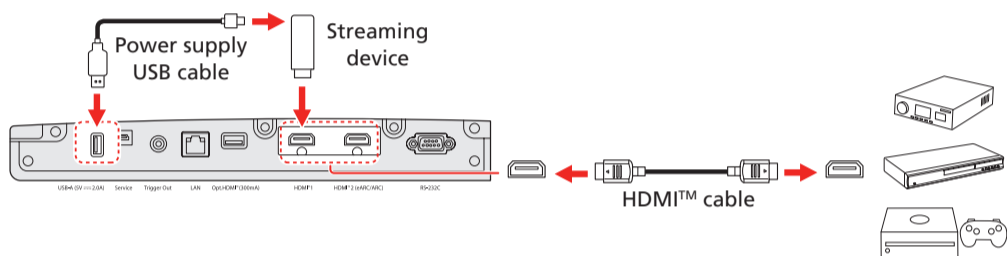

**Note:**

- When projecting images at 4K 120Hz, use an HDMI 2.1 rated cable (ultra-high speed).
- You can output audio to an external sound system that supports eARC/ARC using the **HDMI™ 2 (eARC/ARC)** port.
- If you are connecting an optical HDMI cable that has a power supply USB cable, you must also connect the cable's USB power connector to the **Opt.HDMI™ (300mA)** port.

### Wired network

Connect the projector to your network using an Ethernet cable. See "Wired network configuration" for more information.

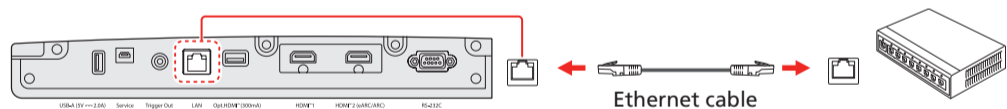

## Turn on your equipment

**1** Plug in the projector.

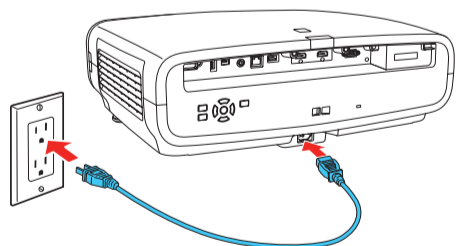

**2** Press the power button on the projector or the **On** button on the remote control. The shutter opens and the power light flashes blue, then stays on.

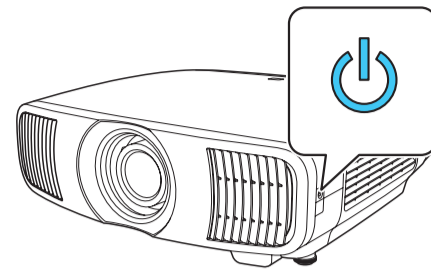

**Note:** To shut down the projector, press the power button on the projector or the **Standby** button on the remote control, then press the button again to confirm, if necessary. Wait for cooldown to complete before unplugging the projector.

**3** Use the arrow and Enter buttons on the remote control to select the focus, image orientation, and language settings.

**Note:** To change these settings, see the online *User's Guide*.

**4** Turn on your video source.

**5** If you don't see an image, press one of the **Source** buttons on the remote control to select the image source.

**Note:** If you still see a blank screen or have other display problems, see the troubleshooting tips on this sheet.

## Using the remote control

Install the batteries as shown (two AA batteries).

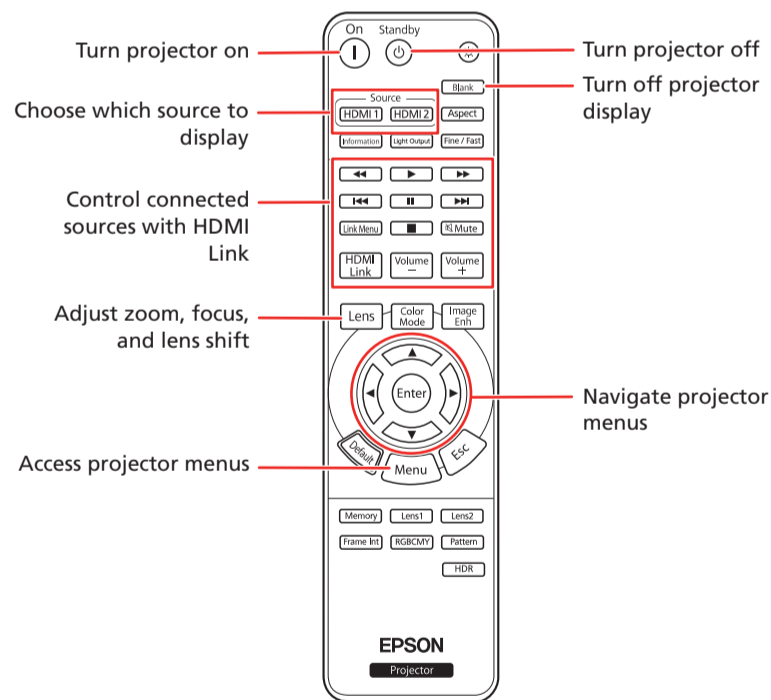
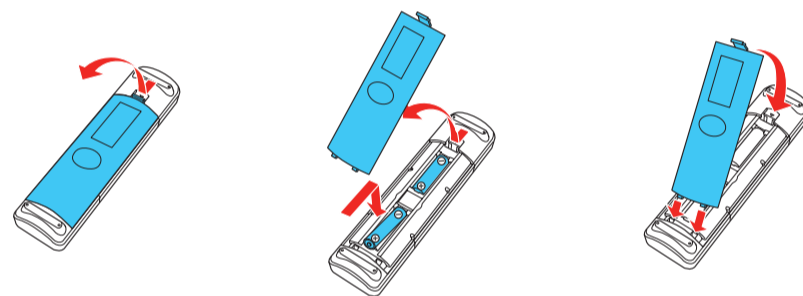

For more information on using the remote control, see the online *User's Guide*.



# Adjust the image

- 1 Press the **Pattern** button on the remote control to display a test pattern.

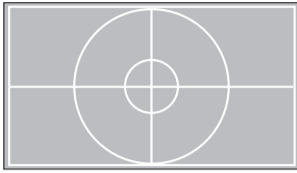

- 2 Press the **Lens** button on the remote control and use the ◀ and ▶ buttons to focus the image.

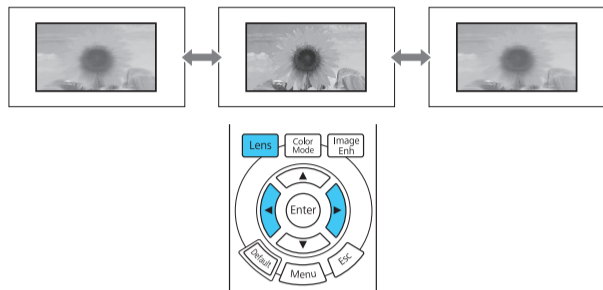

- 3 Press the **Lens** button on the remote control again and use the ◀ and ▶ buttons to reduce or enlarge the image.

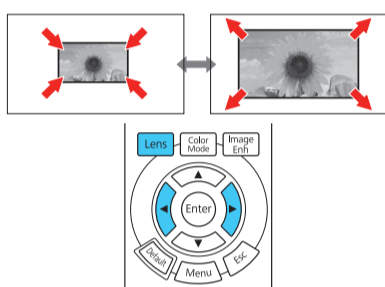

- 4 Press the **Lens** button on the remote control again and use the ▲, ▼, ◀, and ▶ buttons to reposition the image.

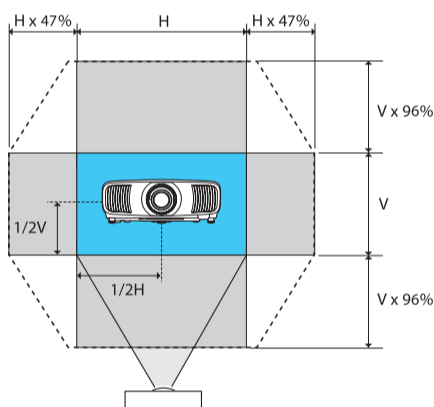

# Wired network configuration

Follow these steps to set up your projector for a wired network connection.

- 1 Press the **Menu** button on the remote control, select the **Network** menu, then press **Enter**.
- 2 Choose **Network Settings** and press **Enter**.
- 3 Select the **Wired LAN** menu and press **Enter**.

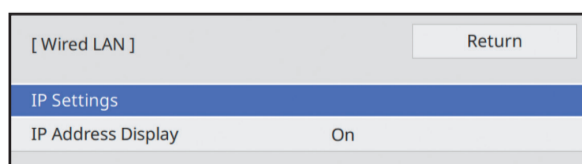

- 4 Choose **IP Settings** and press **Enter**.
- 5 If your network assigns addresses automatically, make sure the **DHCP** setting is on. If not, make sure DHCP is off and enter the projector's **IP Address**, **Subnet Mask**, and **Gateway Address**, as needed. Then press **Esc**.
- 6 To prevent the IP address from appearing on the network standby screen, set the **IP Address Display** setting to **Off**.

- 7 When you are finished, return to the Network Settings menu and select **Set** to apply your settings. Then select **Yes** to save the settings.

**Note:** If you are prompted to enter a password for Epson Web Control, you can create a password or leave it blank. If you do not set a password, you cannot use Epson Web Control.

- 8 Press the **Menu** button to exit the menu system.

# Using web control

You can use a standard web browser to control the projector through the network. A virtual remote control on your computer or mobile device screen lets you perform many of the same functions as you can with the physical remote control.

- 1 Open your web browser and enter the IP address of the projector you want to monitor in the browser's address bar. The Epson Web Control menu opens.

If you're not sure what the IP address of the projector is, turn the projector on and select **Wired LAN Info** from the Network menu to display the IP address of the projector. (Do not enter the leading zeroes.)

- 2 Select **Basic Control** or **Remote**. If you see a login screen, enter **EPSONWEB** as the user name. If a password was created, enter the password.

- 3 Use the on-screen buttons to operate the projector, as you would using the remote control. See the online *User's Guide* for details.

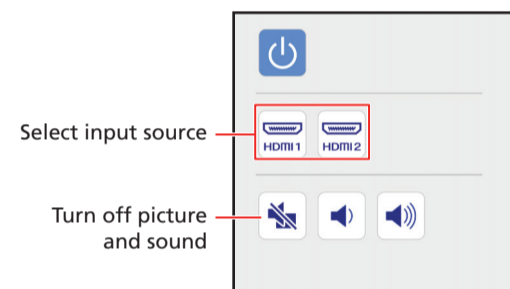

# Troubleshooting

- If you see a blank screen, check the following:
  - Make sure your computer or video device is properly connected.
  - Make sure the power and Status lights on the projector are blue and not flashing.
  - Press the power button on the projector or the remote control to wake the projector from standby or sleep mode, if necessary.
- If you see a blank screen when a computer is connected, check the following:
  - On Windows®, hold down the Windows key and press **P** at the same time, then click **Duplicate**.
  - If you are using a Mac laptop with macOS 13 or newer, select **System Settings > Displays**. Select the projector, then choose the mirror option for your display from the Use as pop-up menu.
  - On macOS 12, select **System Preferences > Displays > Display Settings**. Select the projector, then choose the mirror option for your display from the drop-down menu.
  - On macOS 11 and older, open **System Preferences** and select **Displays**. Click the **Arrangement** tab and select the **Mirror Displays** checkbox.
- If the projector does not respond to remote control commands, make sure the batteries in the remote control are installed correctly. Replace the batteries, if necessary.

# Registration

Scan the QR code to register for product updates and exclusive offers.



## Where to get help

### Manual

For more information about using the projector, you can view or download the online manual from the Epson website, as described below.

### Internet support

Visit <http://epson.com/support> (U.S.), <http://epson.ca/support> (Canada), or <http://latin.epson.com/support> (Latin America) and search for your product to download software, view manuals, get FAQs and troubleshooting advice, or contact Epson.

### Telephone support services

To use the Epson® PrivateLine® Support service, call (800) 637-7661 (U.S. and Canada). This service is available for the duration of your warranty period. You may also speak with a support specialist by calling (562) 276-4394 (U.S.) or (905) 709-3839 (Canada).

Support hours are 7 a.m. to 4 p.m., Pacific Time, Monday through Friday. Days and hours of support are subject to change without notice. Toll or long-distance charges may apply.

In Latin America, see the online *User's Guide* for technical support information.

## Optional accessories

For a list of optional accessories, see the online *User's Guide*.

You can purchase accessories from an Epson-authorized reseller in the U.S. and Canada. To find the nearest reseller, call 800-GO-EPSON (800-463-7766). Or you can purchase online at <http://epsonstore.com> (U.S. sales) or <http://epsonstore.ca> (Canadian sales).

To find the nearest reseller in Latin America, go to <http://latin.epson.com>.

## Notices

### Supplier's Declaration of Conformity

According to 47CFR, Part 2 and 15, Class B Personal Computers and Peripherals; and/or CPU Boards and Power Supplies used with Class B Personal Computers

We: Epson America, Inc.  
Located at: 3131 Katella Ave.  
Los Alamitos, CA 90720  
Telephone: (562) 981-3840

Declare under sole responsibility that the product identified herein, complies with 47CFR Part 2 and 15 of the FCC rules as a Class B digital device. Each product marketed, is identical to the representative unit tested and found to be compliant with the standards. Records maintained continue to reflect the equipment being produced can be expected to be within the variation accepted, due to quantity production and testing on a statistical basis as required by 47CFR § 2.906. Operation is subject to the following two conditions: (1) this device may not cause harmful interference, and (2) this device must accept any interference received, including interference that may cause undesired operation.

Trade Name: Epson  
Type of Product: LCD Projector  
Model: HB23A  
Options: Remote controller (model 2214345 xx [x=0-9])

### U.S. FCC Notices

This device complies with Part 15 of the FCC Rules. Operation is subject to the following two conditions: (1) This device may not cause interference, and (2) this device must accept any interference received, including interference that may cause undesired operation.

This equipment has been tested and found to comply with the limits for a Class B digital device, pursuant to Part 15 of the FCC Rules. These limits are designed to provide reasonable protection against harmful interference in a residential installation. This equipment generates, uses, and can radiate radio frequency energy and, if not installed and used in accordance with the instructions, may cause interference to radio communications. However, there is no guarantee that interference will not occur in a particular installation. If this equipment does cause interference to radio and television reception, which can be determined by turning the equipment off and on, the user is encouraged to try to correct the interference by one of the following measures:

- Reorient or relocate the receiving antenna.
- Increase the separation between the equipment and receiver.
- Connect the equipment into an outlet on a circuit different from that to which the receiver is connected.
- Consult the dealer or an experienced radio/TV technician for help.

**WARNING:** The connection of a non-shielded equipment interface cable to this equipment will invalidate the FCC Certification or Declaration of this device and may cause interference levels which exceed the limits established by the FCC for this equipment. It is the responsibility of the user to obtain and use a shielded equipment interface cable with this device. If this equipment has more than one interface connector, do not leave cables connected to unused interfaces. Changes or modifications not expressly approved by the manufacturer could void the user's authority to operate the equipment.

**WARNING:** MOUNT ABOVE THE HEADS OF CHILDREN. The use of a ceiling mount is recommended with this product to place it above the eyes of children.

Complies with FDA performance standards for laser products except for conformance as a Risk Group 2 LIP as defined in IEC 62471-5: Ed. 1.0. For more information see Laser Notice No. 57, dated May 8, 2019.

### Industry Canada (IC) Notices

CAN ICES-3 (B)/NMB-3 (B)

**WARNING:** MOUNT ABOVE THE HEADS OF CHILDREN. The use of a ceiling mount is recommended with this product to place it above the eyes of children.

Complies with FDA performance standards for laser products except for conformance as a Risk Group 2 LIP as defined in IEC 62471-5: Ed. 1.0. For more information see Laser Notice No. 57, dated May 8, 2019.

**EPSON®**



EPSON is a registered trademark and the EPSON logo is a registered logomark of Seiko Epson Corporation.

PrivateLine is a registered trademark of Epson America, Inc.

Mac and macOS are trademarks of Apple Inc., registered in the U.S. and other countries.

Windows is a trademark of the Microsoft group of companies.

General Notice: Other product names used herein are for identification purposes only and may be trademarks of their respective owners. Epson disclaims any and all rights in those marks.

This information is subject to change without notice.

© 2024 Epson America, Inc., 4/24  
Printed in XXXXXX

CPD-64529