

# Cuisinart®

## 3.1 Cu. Ft. Compact Refrigerator

CCF-31



Instruction  
Booklet

For your safety and continued enjoyment of this product, always read the instruction book carefully before using.

# IMPORTANT SAFEGUARDS

When using an electrical appliance, basic safety precautions should always be taken, especially when children are present, to reduce the risk of fire, electric shock, and personal injury, including the following:

1. Use this appliance only as described in this manual. Other uses not recommended may cause fire, electric shock, or personal injury.
2. This product is intended for household use only.
3. To protect against electric shock, do not immerse unit, plug, or cord in water or spray with liquids.
4. Close supervision is necessary when any appliance is used by or near children.
5. Unplug from the outlet when not in use, when moving from one location to another, and before cleaning.
6. To disconnect the appliance, grip the plug and pull it from the wall outlet. Never pull by the cord.
7. Do not operate the appliance in the presence of explosives and/or flammable fumes.
8. Do not place the appliance or any of its parts near an open flame, cooking, or other heating appliance.
9. Do not operate the appliance with a damaged cord or plug, if the product malfunctions, or if it is dropped or damaged in any manner.
10. The use of attachments not recommended by the manufacturer may be hazardous.
11. Place the unit on a dry, level surface.
12. If you are replacing an appliance that has a spring lock or latch on the door or lid, make the latch unusable before discarding the appliance so that a child can't accidentally become trapped inside and suffocate.
13. A loose fit between the AC outlet (receptacle) and plug may cause overheating and a distortion of the plug. Contact a qualified electrician to replace loose or worn outlet.
14. This appliance is designed to be freestanding only, and should not be recessed or built in (fully recessed).
15. Locate the unit away from direct sunlight and sources of heat (stove, heater, radiator, etc.). Direct sunlight will affect/alter the outside color of the appliance.
16. Be careful not to damage refrigeration circuits or the unit's power cord. Any damage to the cord or plug may cause a short circuit and could potentially lead to electric shock or fire.
17. To prevent items falling and causing injury or damage to the appliance, do not overload the racks.
18. **CAUTION:** Flammable refrigerant used! When handling, moving, and using the unit, be sure to avoid either damaging the refrigerant tubing, or and increasing the risk of leak.
19. This appliance is not intended for use by persons (including children) with reduced physical, sensory, or mental capabilities, or lack of experience and knowledge, unless they have been given supervision or instruction concerning use of the appliance by a person responsible for their safety.
20. Use by children should be supervised to prevent them from playing with or otherwise misusing the appliance.
21. Keep packing materials out of reach of children. These materials are potentially hazardous. During unit disposal, observe local standards for this type of waste material.
22. Do not touch the hot compressor at the rear bottom of the appliance, as this may cause physical injury. Keep children away from the rear of appliance.
23. Never allow children to hang or stand on the doors or racks.

24. **DANGER:** Risk of child entrapment. Before you throw away your old unit: Take off the doors. Leave the shelves in place so that children may not easily climb inside.
25. To avoid the risks that are always present when using an electric appliance, we recommend that you follow the instructions.
26. Unpack the appliance and carefully check the interior and exterior. Should any damage be evident, do not plug in the appliance. Instead, immediately contact the store where you purchased it.
27. Do not use electrical appliances inside the food storage compartments of the appliance, unless they are of the type recommended by the manufacturer.
28. If the supply cord is damaged, it must be replaced by the manufacturer, its service agent, or similarly qualified person in order to avoid a hazard.
29. Do not store explosive substances such as aerosol cans with a flammable propellant in this appliance.
30. If you are discarding the appliance, pull the plug out of the socket, cut the connection cable (as close to the appliance as you can), and remove the door to prevent playing children to suffer electric shock or to close themselves into it.
31. Do not use extension cords or unground(two prong) adapters

## WARNING

To reduce the risk of fire, electric shock, or personal injury, unplug or disconnect the appliance from the power supply before servicing.

- Keep ventilation openings, in the appliance enclosure or in the built-in structure, clear of obstruction.
- Do not use mechanical devices or other means to accelerate the defrosting process, other than those recommended by the manufacturer.
- Do not damage the refrigerant circuit.
- Do not touch the light bulb if it has been on for a long period of time because it could be very hot.

## SAVE THESE INSTRUCTIONS FOR HOUSEHOLD USE ONLY SPECIAL CORD SET INSTRUCTIONS NOTICE

For your protection, this unit is equipped with a 3-conductor cord set that has a molded 3-prong grounding-type plug, and should be used in combination with a properly connected grounding-type outlet as shown in figure A.

**NOTE: Do not remove the grounding prong.**

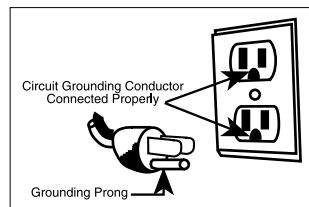

# CONTENTS

Important Safeguards . . . . .	2
Unpacking Your Compact Refrigerator . . . . .	4
Reversing the Door . . . . .	4
Features . . . . .	6
Setting Up Your Compact Refrigerator . . . . .	6
Select The Right Location . . . . .	6
Proper Air Circulation . . . . .	6
Electrical Requirements . . . . .	6
Leveling Your Refrigerator . . . . .	7
Using Your Refrigerator . . . . .	7
Operating Instructions . . . . .	8
Temperature Control . . . . .	8
Helpful Hints for Food Storage . . . . .	8
How To Change The Interior Light . . . . .	7
Cleaning And Care . . . . .	8
Defrosting . . . . .	8
Power Interruptions . . . . .	8
Moving Your Compact Refrigerator . . . . .	8
Be Sure the Refrigerator Remains Upright at All Times . . . . .	8
Tips For Saving Energy . . . . .	9
Troubleshooting . . . . .	10
Warranty . . . . .	11

# UNPACKING YOUR COMPACT REFRIGERATOR

Unpack your refrigerator and carefully check the interior and exterior. Should any damage be evident, do not plug the appliance in. Contact the store from which you purchased it.

This unit must always be kept upright before, during, and after unpacking.

# REVERSING THE DOOR

**Tools required:** Phillips screwdriver, flat-bladed screwdriver, adjustable wrench.

Ensure the unit is unplugged and empty. To take the door off; it is necessary to tilt the unit backwards. You should rest the unit on something solid so that it will not slip during the door reversing process. Save all parts for the reinstallation of the door.

**Do not lay the unit flat as this may damage the coolant system.**

1. Carefully remove the top hinge cover with a flat screwdriver.

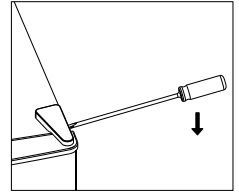

2. Unscrew the top hinge with a Phillips screwdriver.

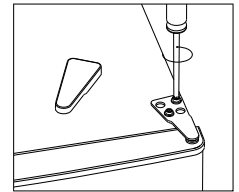

3. Remove the hole cover with a flat screwdriver.

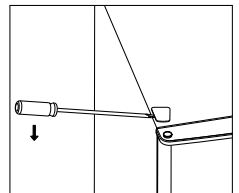

4. Move the core cover from left side to right side. And then lift the upper door and place it on a padded surface to prevent scratches.

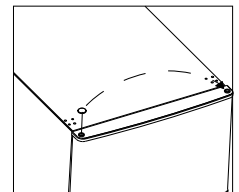

5. Unscrew the middle hinge and then lift the bottom door and put it on a soft pad to prevent scratches.

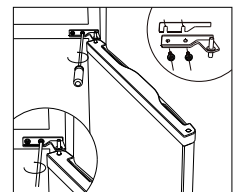

6. Move two middle hole covers from left to right.

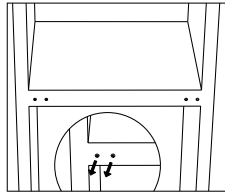

7. Lie down the rear of cabinet on a soft pad. Unscrew the bottom hinge and leveling foot.

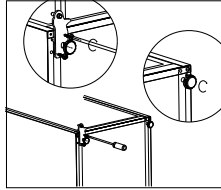

8. Unscrew and remove the bottom hinge pin, turn the bracket over and replace it.

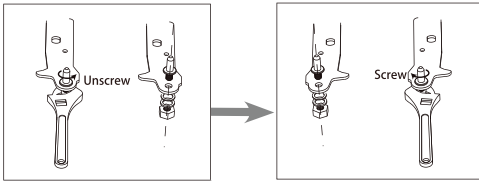

9. Install the hinge at left side and foot base at right side. Then screw two leveling feet with their original parts.

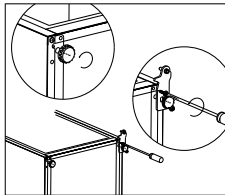

10. Move two middle hole covers from left to right.

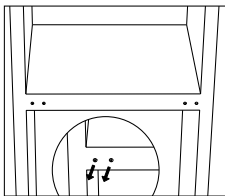

11. Lie down the rear of cabinet on a soft pad. And unscrew the bottom hinge and leveling foot.

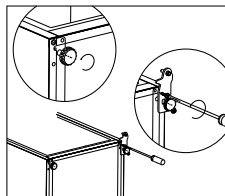

12. Stand up the unit and put the door on the bottom hinge. Make sure the bottom hinge core is inserted in the door hole. Then move the hinge hole cover of bottom door from left side to right side.

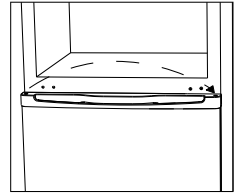

13. Install the middle hinge.

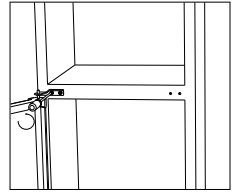

14. Install the upper door with the upper hinge.

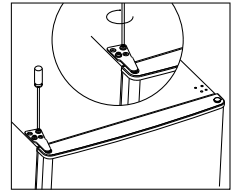

15. Place the hinge cover and screw cover back on.

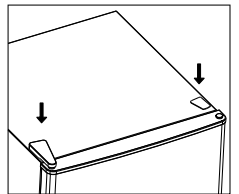

# FEATURES

1. Freezer Compartment
2. Temperature Control (with light)
3. Glass Shelf
4. Crisper with Glass Cover
5. Leveling Legs
6. Freezer Door Storage
7. Door Storage Bins

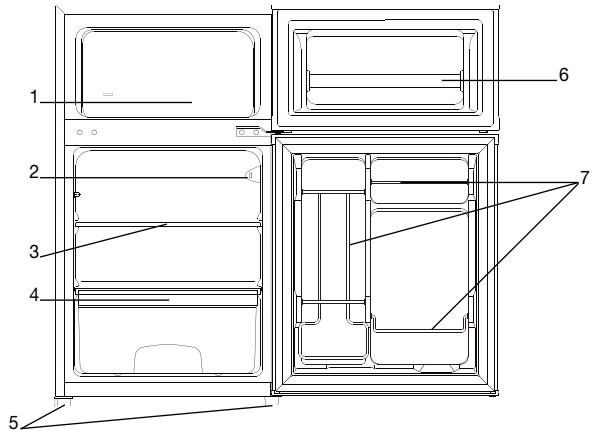

# SETTING UP YOUR COMPACT REFRIGERATOR

**ALWAYS REMOVE ALL FOOD AND BEVERAGES BEFORE MOVING THE REFRIGERATOR**

## Select the Right Location

**NOTE: The refrigerator is designed for freestanding operation. It is not made to be recessed or built-in (fully recessed).**

The refrigerator must be positioned on a flat surface that is strong enough to support it when fully loaded.

Choose a location where there is no risk of extreme temperatures, either hot or cold, such as a garage that is not properly insulated or heated.

The refrigerator should be installed well away from sources of heat such as radiators, boilers, or direct sunlight. Ensure that air can circulate freely around the back of the cabinet. To ensure best performance, if the unit is positioned below an overhanging structure, the minimum distance between the top of the cabinet and the structure must be at least 4 inches. Ideally, the refrigerator should not be positioned below overhanging structures. Accurate leveling is ensured by one or more adjustable feet at the base of the cabinet.

**WARNING: It must be possible to disconnect the appliance from the main power supply; the plug must be easily accessible after installation.**

**NOTE: Allow enough space in the front of the unit to open the door.**

## Proper Air Circulation

To ensure that your refrigerator works at the maximum efficiency for which it was designed, you should install it in a location that has proper air circulation and electrical connections.

The refrigerator is designed to be freestanding and should not be recessed or built in. Allow 2 inches of space on both sides and back of the unit to allow proper ventilation.

To ensure proper internal air circulation, do not overfill your refrigerator.

## Electrical Requirements

Your refrigerator requires a power outlet (120V, 15amps) with proper grounding. Avoid placing the unit where there may be electrical interference.

Do not plug unit into the same outlet that has another refrigerator or microwave.

Avoid the use of three-prong plug adapters. Do not cut off the grounding prong to accommodate a two-plug outlet; that could result in a shock hazard.

Before plugging in, ensure that the voltage and frequency shown on the rating plate correspond to your domestic power supply. The appliance must be earthed. The power supply cable plug is provided with a contact for this purpose. If the domestic power supply socket is not earthed, connect the appliance to a separate earth in compliance with current regulations, consulting a qualified electrician.

The manufacturer declines all responsibility if the above safety precautions are not observed.

**NOTE: Do not place heavy objects on top of the refrigerator.**

**To minimize the risk of rusting, leakage, and insulation damage, avoid placing the unit where heavy moisture is present. Under no circumstances apply or let water spill onto or into the unit.**

## Leveling Your Refrigerator

Your refrigerator has 2 leveling legs. After properly placing your unit in its final position, adjust the legs by turning them clockwise to raise the refrigerator or counterclockwise to lower it. If the unit is not level, the doors and magnetic seal will not be aligned properly.

## Using Your Refrigerator

### Important:

- Before connecting the refrigerator to a power source, let it stand upright for approximately 24 hours. This will reduce the risk of any malfunction to the cooling system that might have occurred during handling and/or transporting, and will allow the refrigerant to flow back into the compressor.
- When using the refrigerator for the first time, allow at least 24 hours for the internal temperature to adjust properly.

Your refrigerator should be on a flat surface that is strong enough to support it when fully loaded.

## Operating instructions

Before using the refrigerator for this first time, clean the interior with a damp cloth. Wipe down the shelves and interior walls, and dry with soft cloth.

## Temperature Control

The internal temperature is controlled by a thermostat. There are 8 settings. 1 is warmest setting, 7 is coldest setting, and 0 is off.

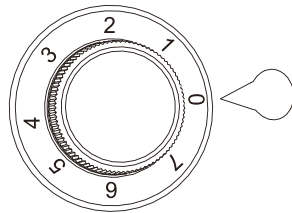

## Helpful Hints for Food Storage

- When storing fresh food that is not prepackaged, be sure to wrap or store food in airtight and moistureproof material unless otherwise noted. This will ensure proper shelf life and prevent the transfer of odors and tastes.
- Wipe containers before storing to avoid needless spills.
- Hot food should be allowed to cool before storing in the refrigerator. This will prevent unnecessary energy use.
- When storing meats in the refrigerator, keep in the original packaging or rewrap as necessary.

## How to Change the Interior Light

**Warning: Before replacing the light bulb, disconnect the refrigerator from main power supply.**

Follow below process to replace the lightbulb:

1. Set the temperature regulation knob at number "0" to switch off.
2. Remove the screw of the lamp cover.

3. Pull the lamp cover out.
4. Unscrew the light bulb.
6. Twist new bulb in the the opposite direction of unscrewing, then replace the lamp cover and screw in.
7. Plug in the refrigerator and set the thermostat to usual setting.

## Cleaning and Care

**Warning: To avoid electric shock, always unplug your refrigerator before cleaning. Ignoring this warning may result in death or injury.**

**Caution: Before using cleaning products, always read and follow manufacturer's instructions and warnings to avoid personal injury or product damage.**

### General Cleaning

Unplug the unit and remove all food and beverages and shelves.

#### Interior

Wipe down walls with a solution of 2 tablespoons of baking soda dissolved in 1 quart of water. Rinse with clean, warm water. Dry with soft cloth. Vacuum any dust or particles blocking the vent, compressor, or evaporator (blockage could hinder cooling efficiency of your unit).

#### Exterior

Clean with mild detergent and damp cloth. Rinse with warm water and dry with soft cloth.

Be sure the door gasket is kept clean to ensure proper seal.

#### Cleaning the drain hole

To avoid defrost water overflowing into the fridge, periodically clean the drain hole at back of fridge compartment. Use a paper towel to wipe anyway any excess water or debris.

## Defrosting

When ice forms in the freezer, follow the steps below to defrost:

1. Unplug the refrigerator and ensure the cord is in a safe, dry location.
2. Remove all stored food and beverages and put in a cool place.
3. Place a container or tray underneath the the refrigerator to collect the defrost water.
4. The defrost process may take a few hours. To speed up the defrost time, keep the door open and place a bowl of warm water in the refrigerator. Never use sharp objects to remove the frost.
5. When defrosting is completed, dry the interior thoroughly and plug the unit back in.

## Power Interruptions

If power is interrupted due to a storm or other cause, the unit will power off and automatically restart after 3 to 5 minutes. You cannot restart the unit before this time delay.

If the unit is unplugged, once it is plugged back in, it will take 3 to 5 minutes to restart.

## Moving Your Compact Refrigerator

Before moving, unplug the unit, remove all food and beverage, and clean the unit following the directions under CLEANING.

Replace shelves and tie or tape the door to secure it in the closed position before moving the unit.

## Be Sure the Refrigerator Remains Upright at All Times.

Any other servicing should be performed by an authorized service representative. Don't try to repair the refrigerator yourself. It is dangerous to alter or modify this product in any way. The component parts need to be replaced with like components and servicing needs to be done by factory-



authorized service personnel to minimize the risk of possible ignition due to incorrect parts or improper service.

Dealer will not be responsible for any damage or defects caused by or resulting from repairs, service, conversion, or alterations to the product or any of its parts and accessories that have been performed by service centers or repairmen not authorized by dealer. Dealer will not be responsible for any direct, indirect, or consequential damages, losses, or other costs and expenses resulting from any spoilage of any items stored in this refrigeration system.

## **TIPS FOR ENERGY SAVING**

1. The unit should be located in the coolest area of the room, away from sunlight, heat-producing appliances, or heat sources, and should never be exposed to extreme temperatures.
2. Ensure that the door is properly closed when the unit is turned on.
3. Always keep your refrigerator well ventilated. Never block the vent, compressor, or evaporator openings on interior or exterior of unit.
4. If the room is hot or humid, minimize the opening and closing of the refrigerator.
5. Don't put hot food in the refrigerator
6. Don't pack food close together as this prevents air circulating.
7. If electricity goes off, refrain from opening the door.

# TROUBLESHOOTING

**Caution!** Before troubleshooting, disconnect from the power supply. Only a qualified electrician or trained person must do the troubleshooting that is not in this manual.

**Important!** Please be aware that there will be some sounds created during normal use (compressor, refrigerant circulation).

SYMPTOM	POSSIBLE CAUSE
Refrigerator does not seem to be working or on	The temperature knob may be set at 0. Set the knob to desired number to switch on the unit.
	Plug may not be plugged in all the way or loose. Remove and insert into socket.
The food is not cold enough	Temperature may not be properly adjusted. Please look in the Temperature Control section on page 7.
	If a large quantity of warm food was placed in the refrigerator within the last 24 hours, colder air is needed. Turn the Thermostat to a colder setting temporarily.
	If the refrigerator is installed near a heater, it may be slowing down the cooling in the refrigerator. Move the refrigerator away from anything radiating heat.
Food and beverages are too cold	Turn the Thermostat to a warmer setting temporarily.
Unusual noises	The refrigerator is not level. You may need to readjust the feet.
	Move the unit slightly if it is touching the wall or other objects.
Water leaking onto the floor	Water drain hole may be blocked; see cleaning instructions on page 8.

# WARRANTY

## Limited 1-Year Warranty

This warranty is available to U.S. consumers only who purchase products directly from Cuisinart® or an authorized Cuisinart® reseller only. You are a consumer if you own a 3.1 Cu. Ft. Compact Refrigerator that was purchased at retail for personal, family, or household use. Except as otherwise required under applicable law, this warranty is not available to retailers or other commercial purchasers or owners or consumers who purchase from unauthorized Cuisinart® resellers. We warrant that your Cuisinart® 3.1 Cu. Ft. Compact Refrigerator will be free of defects in materials and workmanship under normal home use for one year from the date of original purchase.

We recommend that you visit our website, <https://cuisinart.registria.com>, for a fast, efficient way to complete your product registration. However, product registration does not eliminate the need for the consumer to maintain the original proof of purchase in order to obtain the warranty benefits. In the event that you do not have proof of purchase date, the purchase date for purposes of this warranty will be the date of manufacture.

## CALIFORNIA RESIDENTS ONLY

California law provides that for In-Warranty Service, California residents have the option of returning a nonconforming product (A) to the store where it was purchased or (B) to another retail store that sells Cuisinart products of the same type. The retail store shall then, according to its preference, either repair the product, refer the consumer to an independent repair facility, replace the product, or refund the purchase price less the amount directly attributable to the consumer's prior usage of the product. If neither of the above two options results in the appropriate relief to the consumer, the consumer may then take the product to an independent repair facility, if service or repair can be economically accomplished. Cuisinart and not the consumer will be responsible for the reasonable cost of such service, repair, replacement, or refund for nonconforming products under warranty. California residents may also, according to their preference, return nonconforming products directly to Cuisinart for repair or, if necessary, replacement by calling our

Consumer Service Center toll-free at **1-800-726-0190**. Cuisinart will be responsible for the cost of the repair, replacement, and shipping and handling for such nonconforming products under warranty.

## HASSLE-FREE REPLACEMENT WARRANTY

Your ultimate satisfaction in Cuisinart products is our goal, so if your Cuisinart® 3.1 Cu. Ft. Compact Refrigerator should fail within the generous warranty period, we will repair it or, if necessary, replace it at no cost to you. To obtain a return shipping label, email us at <https://www.cuisinart.com/customer-care/product-assistance/product-inquiry/>. Or call our toll-free customer service department at **1-800-726-0190** to speak with a representative.

Your Cuisinart® 3.1 Cu. Ft. Compact Refrigerator has been manufactured to the strictest specifications and has been designed for use only in 120-volt outlets and only with authorized accessories and replacement parts. This warranty expressly excludes any defects or damages caused by attempted use of this unit with a converter, as well as use with accessories, replacement parts, or repair service other than those authorized by Cuisinart. This warranty does not cover any damage caused by accident, misuse, shipment, or other than ordinary household use. This warranty excludes all incidental or consequential damages. Some states do not allow the exclusion or limitation of these damages, so these exclusions may not apply to you. You may also have other rights, which vary from state to state.

**Important:** If the nonconforming product is to be serviced by someone other than Cuisinart's Authorized Service Center, please remind the servicer to call our Consumer Service Center at **1-800-726-0190** to ensure that the problem is properly diagnosed, the product is serviced with the correct parts, and the product is still under warranty.

©2023 Cuisinart  
Glendale, AZ 85307  
Printed in China  
23CE090101

HMK IB-18278