

fisher-price®



**Keep this instruction sheet for future reference,
as it contains important information.**

**Requires four AA batteries (included).
Batteries included are for demonstration purposes only.**

**Required tool for battery replacement: Phillips screwdriver (not included).
Only adults should replace batteries.**

Rockin' Record Player™

HXX58 Owner's Manual

Parts

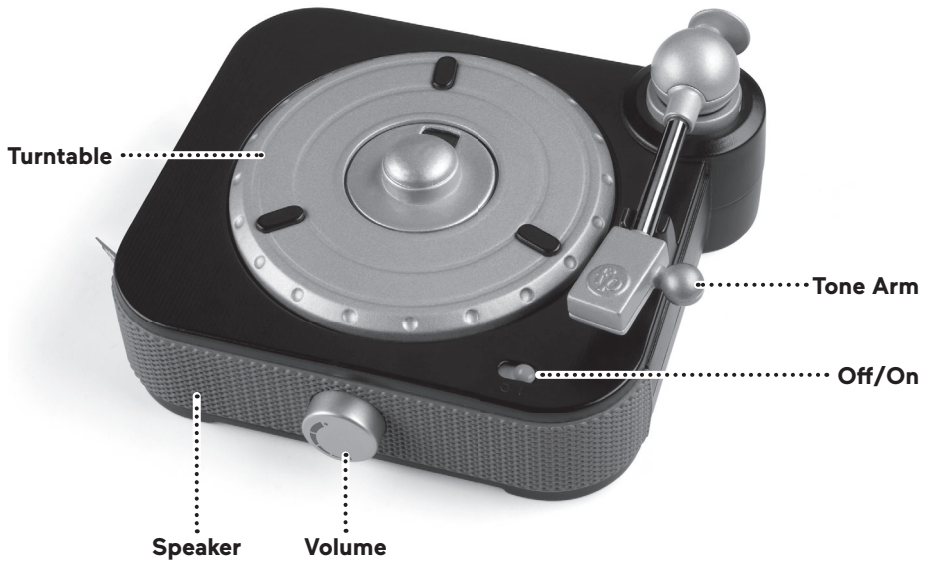
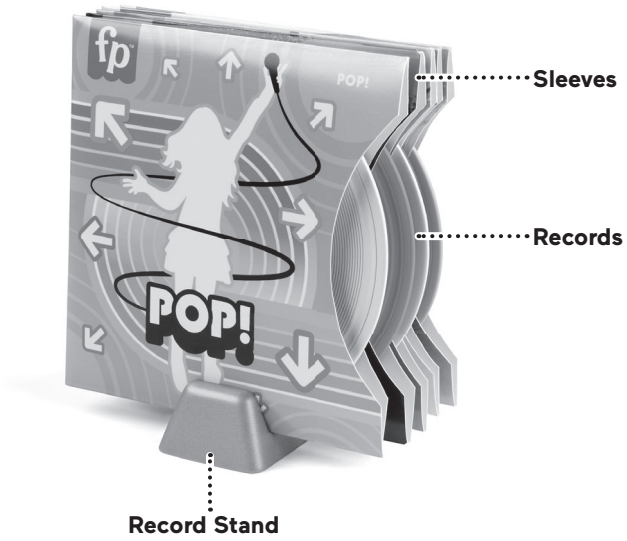

Let's put a record on!



1

Before first time use, remove the paper record from the turntable and properly dispose of it. Make sure to also remove and dispose of any adhesive that may be left on the turntable.

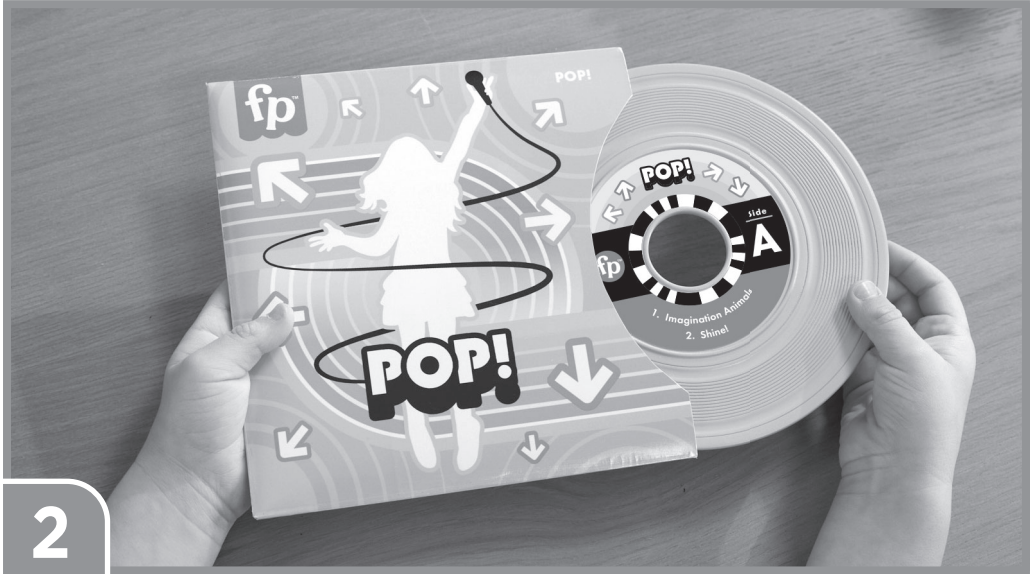

Select a record and remove it from its sleeve.

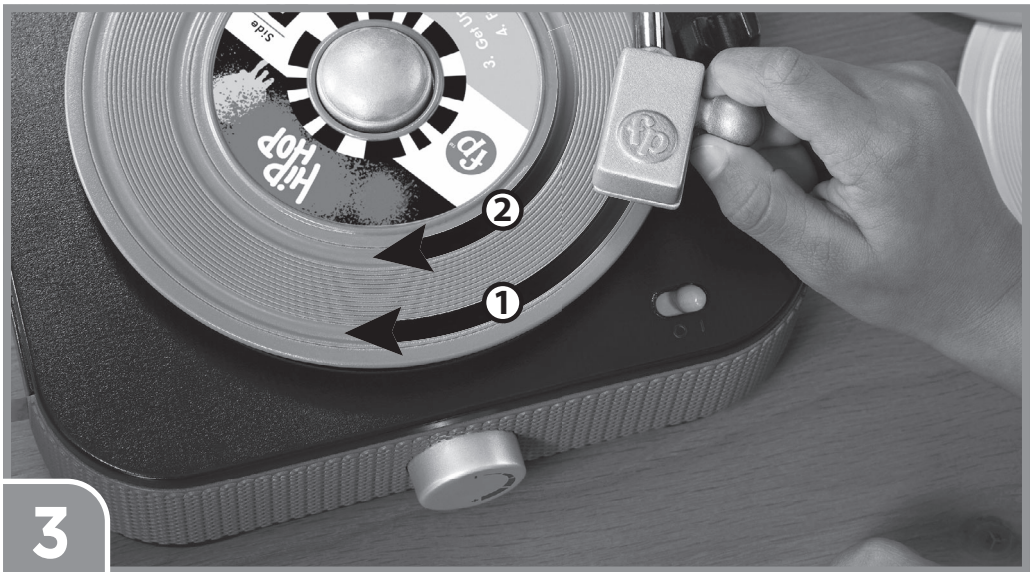

Place the record on the turntable.
Each record has two tracks per side, as indicated by ① and ② in the image above.
Lift the tone arm and place it down onto one of the tracks to begin playing music!



4

Turn the knob to adjust the volume. There are 6 volume levels.

Note: The volume can be turned all the way down to zero. If music should be playing but you don't hear anything, check the volume and turn it up if necessary.



5

Dance to the beat!

If left unattended, the record player will continue to play music for approximately 3-4 minutes. Then, it will stop, and the record player will enter "sleep" mode. To "wake" the record player, lift the tone arm and place it back down onto the record again.

Batteries and Power

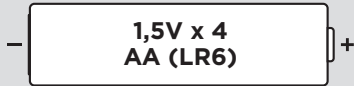

For longer life, use **alkaline** batteries.

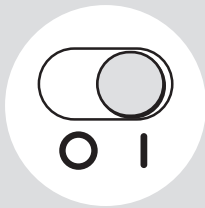
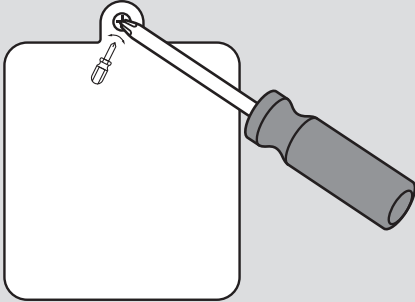

- Locate the battery compartment on the bottom of the record player.
- Loosen the screw in the battery compartment door and remove the door. Remove the exhausted batteries and properly dispose.
- Insert four, new AA (LR6) **alkaline** batteries into the battery compartment.
- Replace the battery compartment door and tighten the screw.
- Slide the power switch to **ON** or **OFF**.
- When sounds or motion become faint, slow or stop, it's time for an adult to change the batteries.
- If this toy begins to operate erratically, you may need to reset the electronics. Slide the power switch off and back on again.

Battery Safety Information

In exceptional circumstances, batteries may leak fluids that can cause a chemical burn injury or ruin your product. To avoid battery leakage:

- Do not mix old and new batteries or batteries of different types: alkaline, standard (carbon-zinc) or rechargeable.
- Insert batteries as indicated inside the battery compartment (+ and -).
- Remove batteries during long periods of non-use. Always remove exhausted batteries from the product. Dispose of batteries safely. Do not dispose of this product in a fire. The batteries inside may explode or leak.
- Never short-circuit the battery terminals.
- Use only batteries of the same or equivalent type, as recommended.
- Do not charge non-rechargeable batteries.
- Remove rechargeable batteries from the product before charging.
- If removable, rechargeable batteries are used, they are only to be charged under adult supervision.



Protect the environment by not disposing of this product or any batteries with household waste. This symbol indicates that this product shall not be treated as household waste. Check your local authority for recycling advice and facilities.

Care

The record player may be wiped with a clean, damp cloth.

Records and sleeves may be wiped with a clean, dry cloth. Do not use water to clean the records as it may damage the label.

Lens

It is important to keep the lens clean. Wipe with a clean, damp cloth.



Records

Take special care to ensure the labels on your records do not become wet or damaged. If damage occurs, the records may no longer function as intended.

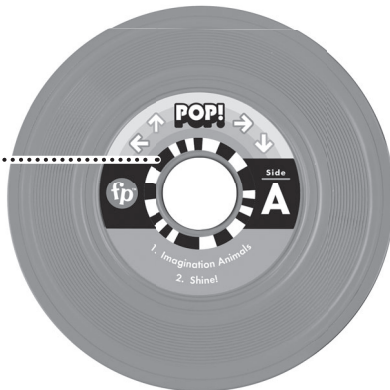



UNITED STATES

Fisher-Price, Inc., 636 Girard Avenue, East Aurora, NY 14052.
Consumer Services: 1-800-432-5437.

CANADA

Mattel Canada Inc., 6155 Freemont Blvd., Mississauga,
Ontario L5R 3W2 Consumer Services/Service à la clientèle :
1-800-432-5437. www.service.mattel.com.

GREAT BRITAIN

Mattel U.K. Limited, The Porter Building, 1 Brunel Way, Slough SL1 1FQ, UK.
www.service.mattel.com/uk.

NEDERLAND

Mattel Europa B.V., Gondel 1, 1186 MJ Amstelveen, Nederland.

AUSTRALIA

Mattel Australia Pty. Ltd., 658 Church Street, Locked Bag #870, Richmond,
Victoria 3121 Australia. Consumer Advisory Service 1300 135 312.

NEW ZEALAND

16-18 William Pickering Drive, Albany 1331, Auckland.

SOUTH AFRICA

Mattel South Africa (PTY) LTD, Office 102 I3, 30 Melrose Boulevard,
Johannesburg 2196.

FCC STATEMENT (UNITED STATES ONLY)

This equipment has been tested and found to comply with the limits for a Class B digital device, pursuant to Part 15 of the FCC rules. These limits are designed to provide reasonable protection against harmful interference in a residential installation. This equipment generates uses and can radiate radio frequency energy and, if not installed and used in accordance with the instructions, may cause harmful interference to radio communications. However, there is no guarantee that interference will not occur in a particular installation. If this equipment does cause harmful interference to radio or television reception, which can be determined by turning the equipment off and on, the user is encouraged to try to correct the interference by one or more of the following measures:

- Reorient or relocate the receiving antenna.
- Increase the separation between the equipment and receiver.
- Consult the dealer or an experienced radio/TV technician for help.

NOTE: Changes or modifications not expressly approved by the manufacturer responsible for compliance could void the user's authority to operate the equipment.

This device complies with Part 15 of the FCC Rules. Operation is subject to the following two conditions: (1) This device may not cause harmful interference, and (2) this device must accept any interference received, including interference that may cause undesired operation.

CAN ICES-3 (B)/NMB-3 (B)

Operation is subject to the following two conditions: (1) this device may not cause interference, and (2) this device must accept any interference, including interference that may cause undesired operation of the device.

L'utilisation de ce dispositif est autorisée seulement aux conditions suivantes : (1) il ne doit pas produire de brouillage et (2) il doit pouvoir tolérer tout brouillage radioélectrique reçu, même si ce brouillage est susceptible de compromettre son fonctionnement.