



Product: 24 Inch Dual Zone Indoor/Outdoor Wine Cooler

Model Number: TWC2401DO

PRODUCT DIMENSIONS

| | |
|---------------------------------------|-----------|
| Cooler Width (in.) | 24 |
| Depth (Excluding Handles) (in.) | 23 13/16" |
| Depth (Including Handles) (in.) | 25 3/8" |
| Depth (Less Door) (in.) | 22 1/16" |
| Depth With Door Open 90 Degrees (in.) | 46 1/16" |
| Height to Top of Door Hinge (in.) | 34 1/4" |
| Product Depth (in.) | 23 13/16" |
| Product Height (in.) | 34 1/4" |
| Product Width (in.) | 23 7/16" |

FEATURES & BENEFITS

- + **Precise Temperature Control** - Electronic temperature control with LED digital display - set temperature anywhere between 41-65°F and the wine cooler will hold it precisely
- + **Dual Temperature Zones** - Store red, white, and sparkling beverages at the appropriate temperature for proper preservation and maximum taste
- + **Maximum Storage Capacity** - Holds up to 46 bottles for maximum storage
- + **Indoor/Outdoor Use** - 304 stainless steel makes it suitable for indoor and outdoor installation
- + **Full-extension Racks** - Full-extension smooth-glide wine racks allows for easy access to your prized vintage collection - the wood front give the metal racks a sleek, high-end design
- + **Interior Lights** - LED interior light so you can easily see what's inside
- + **UV Protection** - Dual pane glass with low-e protects your wine from harmful ultraviolet rays
- + **Proper Storage** - Shake and water proof storage ensure no vibrations and excess humidity, leaving your wine undisturbed and the flavor of the wine at its peak
- + **Charcoal Filtration System** - An active charcoal filtration system to ensures air purity, cooling efficiency and helps to maintain an odor free cabinet for the storage of your wine.
- + **Door Alarm** - Door alarm notifies you if the door is left ajar for too long
- + **Security lock** - Security lock to keep out unwanted guests
- + **Refrigerant:** R600a is an advanced refrigerant that is more efficient and better for the environment

TECHNICAL DETAILS

| | |
|--------------------------------|---|
| Bottle Storage Capacity | 46 |
| Color/Finish | Stainless Steel |
| Voltage (Volts) | 120 |
| Minimum Temperature (F) | 41 |
| Number of Doors | 1 Door |
| Number of Refrigerator Shelves | 6 Shelves |
| Number of Temperature Zones | Double Zone |
| Operational Features | LED, Controls, LED Temperature Controls |
| Product Weight (lb.) | 130 lb |

WARRANTY: 2 YEARS ON PARTS AND LABOR



TWC2401DO Installation

This unit is designed for both built-in or free-standing installation. If you plan to use this unit in a built-in application, please follow the requirements shown below.

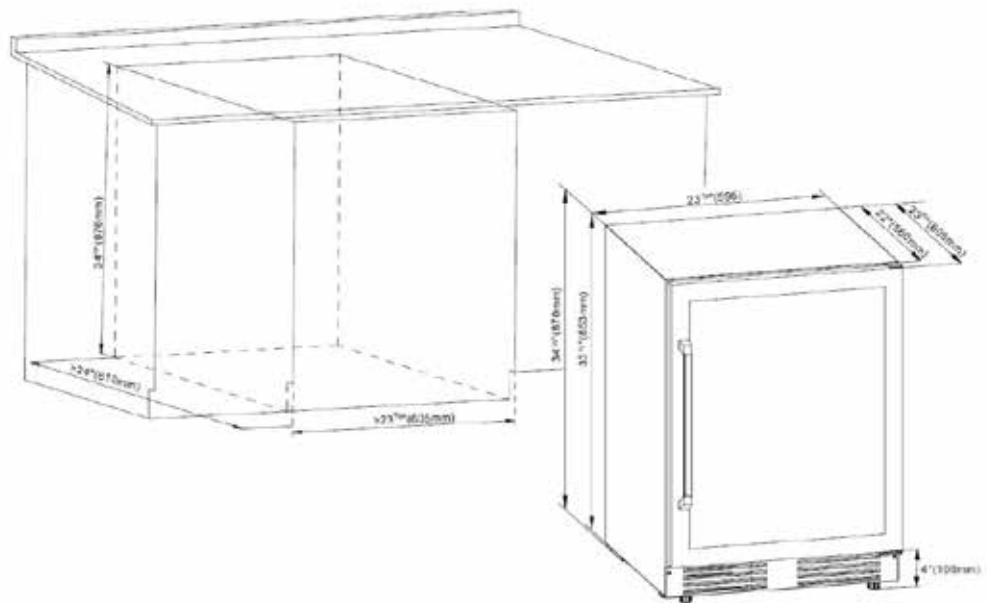

| Cabinet Opening Dimensions | | |
|----------------------------|----------------------------------|----------|
| | IN (min) | CM (min) |
| Width | 23 ⁴ / ₅ " | 60.5 cm |
| Depth | 24" | 61.0 cm |
| Height | 34 ¹ / ₂ " | 87.6 cm |