

USER MANUAL

HAND MIXER

EN

MANUEL DE L'UTILISATEUR

BATTEUR

FR

MANUAL DE USO

BATIDORA

ES



We advise you to read this manual carefully, as it contains all the instructions for managing the appliance's aesthetic and functional qualities.

For further information on the product: [www.smegusa.com](http://www.smegusa.com)

Nous recommandons de lire attentivement ce manuel car il contient toutes les instructions nécessaires à la gestion des qualités esthétiques et fonctionnelles de cet appareil.

Pour plus d'informations sur le produit, consulter le site internet : [www.smegusa.com](http://www.smegusa.com)

Le recomendamos leer detenidamente este manual ya que contiene todas las instrucciones para administrar las cualidades estéticas y funcionales de este aparato.

Para mayores informaciones sobre el producto: [www.smegusa.com](http://www.smegusa.com)

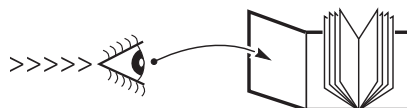

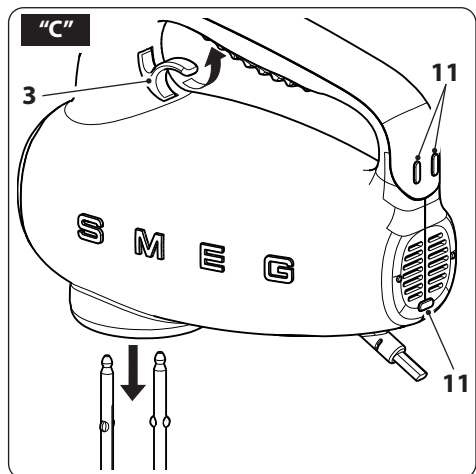
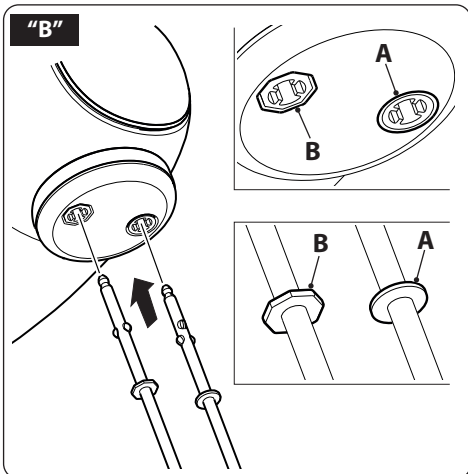
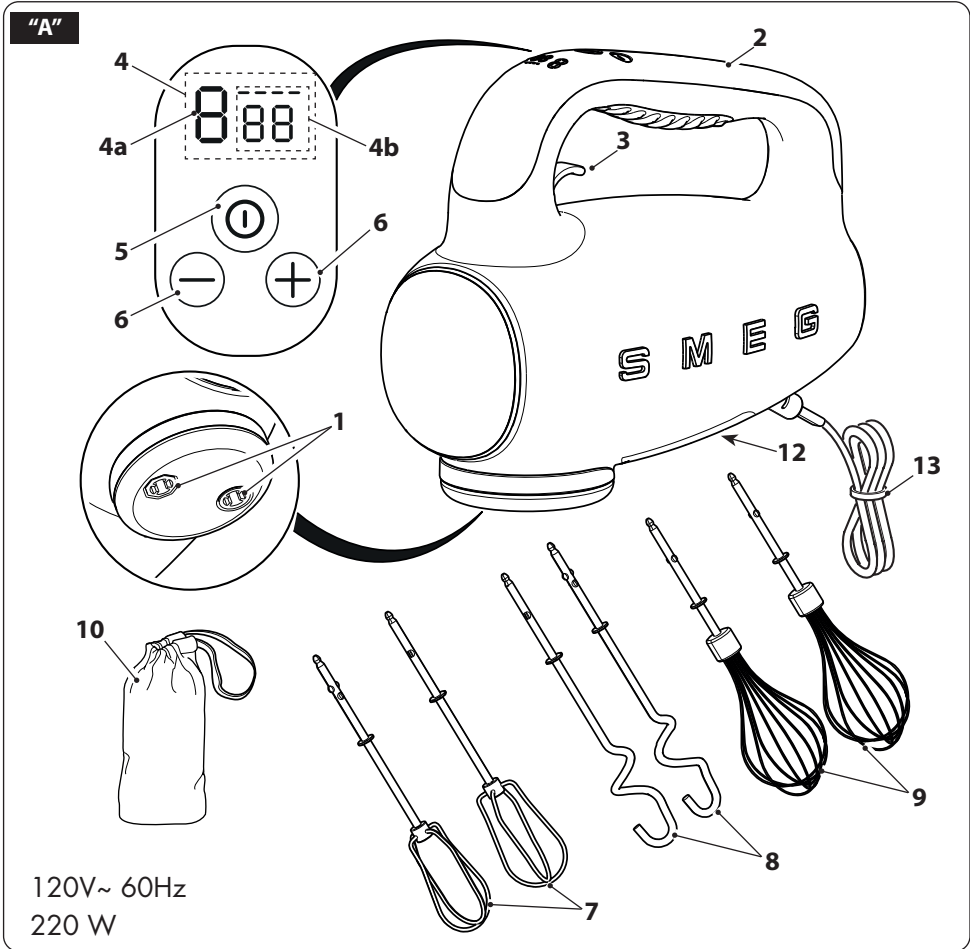

**Important information for the user**  
**Informations importantes pour l'utilisateur**  
**Información importante para el usuario**

 **Instructions / Instructions / Instrucciones**

 **Description / Description / Descripción**

 **Use / Utilisation / Uso**

 **Cleaning and care / Nettoyage et entretien / Limpieza y cuidado**

 **Safety instructions / Consignes de sécurité / Instrucciones de seguridad**

 **Information / Informations / Información**

 **Advice / Conseil / Recomendaciones**



Dear Customer,  
Thank you very much for purchasing the Smeg Line Hand Mixer.  
Our products offer you a solution in which research to create an aesthetically pleasing object and innovative engineering provide unique items that are decorative elements.  
A Smeg appliance is always the perfect match with other products of the line while also being a designer item for the kitchen.  
We hope you fully enjoy all the features of your appliance.  
For more information, please visit: [www.smegusa.com](http://www.smegusa.com)

SMEG S.p.A.

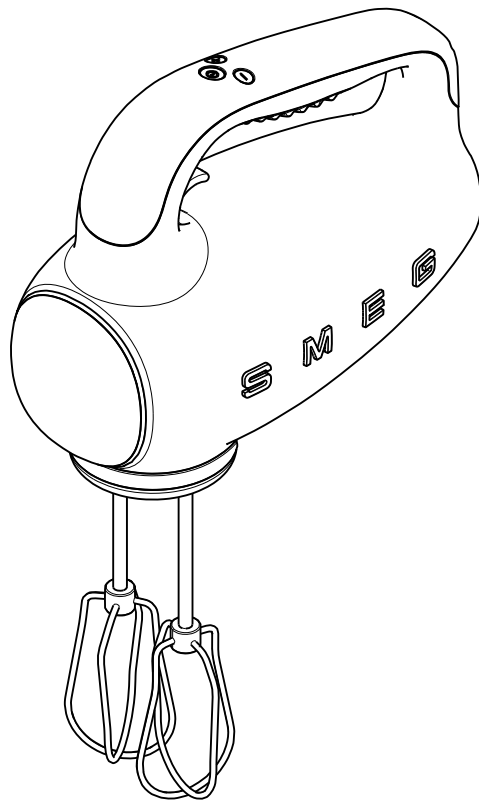

Model HMF01  
Hand mixer



# Important instructions

## Important instructions

**WARNING:** If the instructions contained in this manual are not followed precisely, fire or explosion may result causing property damage, personal injury or death.



### **READ AND SAVE THESE INSTRUCTIONS**

Your safety and the safety of others are very important.

We have provided many important safety messages throughout this manual and on the appliance.

Read all the instructions before using the appliance and always obey all safety messages.

### **WARNING**



• **To reduce the risk of fire or electric shock, do not remove the cover (or back).**

• **No user-serviceable parts inside!**

• **Repair should be done by authorized service personnel only.**



### **RECOGNIZE SAFETY INFORMATION**

This is a safety alert symbol. This symbol alerts you to potential hazards that can result in severe personal injury or death.

### **UNDERSTAND SIGNAL WORDS**

A signal word - DANGER, WARNING or CAUTION - is used with the safety alert symbol. DANGER denotes the most serious hazards. It means you could be killed or seriously injured if you do not immediately follow the instructions.

WARNING means you could be killed or seriously injured if the instructions are not followed. CAUTION indicates a potentially hazardous situation, which, if not avoided, could result in minor to moderate injury.

# Important instructions



## ATTENTION



- This appliance is intended for use in the home only.
- Use this appliance only for its intended purpose. The manufacturer cannot be held liable for damage caused by improper use of this appliance.
- This appliance complies with current safety regulations. Improper use of this appliance can result in personal injury and material damage.
- Read all the instructions before installing or using the appliance for the first time.
- Keep these operating instructions in a safe place and pass them on to any future user.



The safety messages will inform you of potential hazards, on how to avoid the risk of injury and what can occur if the instructions are not followed.

**IMPORTANT: Observe all codes and ordinances in force.**

**WARNING: For your safety, the instructions contained in this manual must be followed to minimize the risk of fire or explosion and to prevent property damage, personal injury or death.**

Do not store or use gasoline or other flammable vapors, liquids or materials near this or any other appliance.



**NOTE:** This appliance is NOT designed for installation in manufactured (mobile) homes or in recreational vehicles (RVs).



### **NOTE:**

**POLARIZED PLUG** (for product manufactured with polarized plug)

This appliance has a polarized plug (one blade is wider than the other). To reduce the risk of electric shock, this plug is designed to fit into a polarized outlet only one way. If the plug does not fit fully into the outlet, flip it over and try again. If it still does not fit, contact a qualified electrician. Do not modify the plug in any way.

**GROUNDING PLUG** (for product manufactured with a grounded plug)

As a safety feature, this product is equipped with grounded plug, which will only fit into a three-prong outlet. Do not attempt to bypass this safety feature. Improper connection of the grounding conductor may result in the risk of electric shock. Consult a qualified electrician if you have any doubts on whether the outlet is properly grounded.



# IMPORTANT SAFEGUARDS

**WARNING** When using electrical appliances, basic safety precautions should always be followed to reduce the risk of fire, electric shock, and / or injury to person including the following:



Follow all safety precautions to ensure safe use of the appliance.

- Before using the appliance, read this user manual carefully.
- Do not use the appliance outdoors.
- This appliance is for household use only.
- Do not use the appliance for other than its intended use.
- Do not allow children to use the appliance.
- Children should not play with the appliance. Keep the appliance out of the reach of children.
- Keep the packaging material (plastic bag) out of the reach of children.
- Close supervision is necessary when any appliance is used by or near children.
- Turn off the appliance immediately after use.
- Do not leave the appliance unattended while it is running.
- Disconnect the appliance from the wall outlet before assembly, disassembly, cleaning and after each use.
- To disconnect, turn any control to the off position, then remove plug from wall outlet.
- Turn the appliance OFF, then unplug from the outlet when not in use, before assembling or disassembling parts and before cleaning. To unplug, grasp the plug and pull from the outlet. Never pull from the power cord.
- The use of attachments not recommended or sold by the manufacturer may cause fire, electric shock or injury.
- Keep hands, hair, clothing, as well as spatulas and other utensils away from beaters during operation to reduce the risk of injury to persons, or damage to the mixer.
- Remove beaters from mixer before washing.
- To protect against fire, electrical shock and personal injury, do not immerse the appliance, the power cord or plug in water or any other liquid.
- Do not touch the appliance or the plug with wet hands.
- Never try to extinguish a flame/fire with water: turn off the appliance, unplug it from the outlet and cover the flame with a lid or a fire blanket.
- Do not use the appliance if the power cord or plug is damaged or if the appliance has been dropped or damaged in any way.
- Do not let cord hang over edge of table or counter, or touch hot surfaces.
- Do not operate any appliance with a damaged cord or plug or after the appliance malfunctions, or has been damaged in any manner. Return appliance to an authorized service facility for examination, repair or adjustment.
- Make sure the power cord does not come in contact with sharp edges.

## SAVE THESE INSTRUCTIONS



# IMPORTANT SAFEGUARDS

- Do not pull on the cord to remove the plug from the socket.
- Do not place the appliance on or near switched-on gas or electric burners, inside an oven, or near heat sources.
- Do not place the appliance near faucets or sinks.
- Never attempt to repair the appliance yourself or without the help of a qualified technician. Failing to do this will void the warranty.
- In case of malfunction, have the appliance repaired by a qualified technician.
- Do not make any changes to the appliance.
- Make sure that the power outlet used is always freely accessible, because only in this way can it be unplugged when necessary.
- To remove the plug from the power outlet, operate directly on the plug. Never pull the cable, it could be damaged.
- If the appliance should break down, do not attempt to repair it.
- Do not allow the power supply cable to dangle over the edge of the table or other surface or to touch hot surfaces.
- If the plug or power supply cable are damaged, have them replaced exclusively by the Technical After-sales centre, so as to prevent all risks.
- Flashing lights ready to operate. Avoid any contacts with blades or moveable parts.

## For this appliance

- Use only original spare parts from the manufacturer. The use of spare parts not recommended by the manufacturer may cause fire, electric shock or injury to persons.
- Avoid wetting or spraying liquid on the appliance. In case of contact with liquid, immediately unplug the cord from the electrical outlet and dry thoroughly: Risk of electric shock!
- Do not use abrasive cleaners or sharp objects to clean the appliance.
- The use of an accessory not evaluated for use with this appliance may cause injuries.
- Do not place the appliance on or in proximity of electric or gas cookers, or in a heated oven.
- This appliance is not intended for use by persons (including children) with reduced physical, sensory, or mental capabilities, or lack of experience and knowledge, unless they are closely supervised and instructed concerning use of the appliance by a person responsible for their safety. Children should be supervised to ensure that they do not play with the appliance.
- This appliance has important markings on the plug blade. Contact a qualified technician to replace the plug with a suitable one if damaged.
- Connect the appliance only to a power outlet installed perfectly.

EN

## SAVE THESE INSTRUCTIONS



# IMPORTANT SAFEGUARDS

- The appliance is intended for household and similar use, such as:
  - in the kitchen area for the staff of shops, offices and other work environments;
  - in bed and breakfast and agritourism accommodation;
  - by guests at hotels and motels, and in residential environments.
- Other uses, in restaurants, bars and cafes for example, are improper.
- With dense mixtures, to prevent overheating, do not use mixing with dough hooks continuously for more than 4 minutes. Leave to cool for 10 minutes before starting a new operation.
- Switch off the appliance and disconnect from supply before charging accessories or approaching parts that move in use.
- Do not block the ventilation or heat dissipation slots.
- Immerse the whips in the bowl with the food before starting the appliance.
- Do not use the appliance for anything other than its intended use. The Hand Mixer is designed for mixing, kneading, whisking eggs or cream.

## **Electrical Cord:**

- a) A short power-supply cord (or detachable power-supply cord) is provided to reduce risks resulting from becoming entangled in or tripping over a longer cord.
- b) Longer detachable power-supply cords or extension cords are available and may be used if care is exercised in their use.
- c) If a long detachable power-supply cord or extension cord is used:
  1. The marked electrical rating of the detachable power-supply cord or extension cord should be at least as great as the electrical rating of the appliance;
  2. If the appliance is of the grounded type, the extension cord should be a grounding-type 3-wire cord; and
  3. The longer cord should be arranged so that it will not drape over the counter top or table top where it can be pulled on by children or tripped over.

## **Connect the appliance**

Make sure that the mains voltage and the frequency correspond with that indicated on the data plate on the bottom of the appliance. Connect the appliance only to a power outlet installed perfectly.

If the plug and power outlet are incompatible, have the power outlet replaced with a suitable type by qualified staff.

# SAVE THESE INSTRUCTIONS

# IMPORTANT INSTRUCTIONS



## This user's manual

This user's manual is an integral part of the appliance and must be kept intact and available to the user throughout its life cycle.

## Use compliant with destination

This appliance is intended for domestic use only.

Furthermore, it can not be used:

- in the kitchen area for employees of shops, in offices or other work environments;
- in farms/farm holiday complexes;
- by customers in hotels, motels and residential environments;
- in bed and breakfast accommodation.

## Manufacturer's liability

The manufacturer declines all liability for damage undergone by persons and objects due to:

- use of the appliance different from that envisioned;
- user manual has not been read;
- tampering of individual parts of the appliance;
- use of non-original spare parts;
- failure to comply with safety recommendations.

## Identification plate

The identification plate lists the technical data, serial number and brand name. The identification plate must never be removed.

## Disposal



Power voltage  
Risk of electric shock

- Unplug the appliance.
- Unplug the cord from the wall outlet.

## Old electrical equipment must not be disposed of with household waste!

In accordance with the law in force, electrical appliances at the end of their life should be taken to separate collection facilities for electrical and electronic waste. This is so that valuable materials from old appliances can be recycled and the environment can be protected. For more information, please contact your local authorities or recycling center employees.

Note that non-polluting and recyclable materials are used for packaging the appliance.

- Dispose of the packaging materials at appropriate differentiated waste collection centers.



Plastic packaging  
Risk of suffocation

- Do not leave the packaging or any part of it unattended.
- Do not allow children to play with the plastic packaging bags.

# SAVE THESE INSTRUCTIONS





## Description / Assembly / Commands

### DESCRIPTION OF THE APPLIANCE (Fig.A)

- 1 Accessory slots
- 2 Handle
- 3 Accessory release trigger
- 4 Speed and timer display
- 5 Start/Stop button
- 6 Speed adjustment buttons
- 7 Optimus beaters
- 8 Dough hooks
- 9 Wire beaters
- 10 Accessory bag
- 11 Feet
- 12 Identification plate
- 13 Cable winding clamp

### IDENTIFICATION PLATE (12)

The identification plate states the technical data, the serial number and marking. The identification plate must never be removed.

### BEFORE COMMISSIONING

- Unpack the appliance carefully and remove all packaging materials and any labels and stickers.
- Clean the motor base using a damp cloth. Wash all components and dry thoroughly (see paragraph "Cleaning and Maintenance").



Before use, check that all components are integral.

### ASSEMBLY OF COMPONENTS (Fig. B)

- Beaters and dough hooks must be inserted into the correct side, and are not interchangeable.
- Insert beater/dough hook with a **round** ring (A) into the **round** slot (A).
- Insert beater/dough hook with **octagonal** ring (B) into the **octagonal** slot (B).



Do not use two accessories of different type together.

### DESCRIPTION OF CONTROLS AND ACCESSORIES

The appliance is equipped with 3 buttons and a time and speed display.

Display (4)	
(4a)	(4b)
	-----
Selected speed	Running timer in minutes
	Running timer in seconds

Buttons			
(5)	 ON - OFF Key		
(6)	<table border="1" style="width: 100%;"> <tr> <td style="text-align: center;">             Decrease speed         </td> <td style="text-align: center;">             Increase speed/            Turbo function            (keep pressed)         </td> </tr> </table>	 Decrease speed	 Increase speed/ Turbo function (keep pressed)
 Decrease speed	 Increase speed/ Turbo function (keep pressed)		

### Optimus beaters (7)

- Use this accessory for semi-hard doughs, medium-consistency creams, chocolate based doughs, pastry doughs, cakes and biscuits doughs, etc.
- Always use both beaters.



### Dough hooks (8)

- Use this accessory for thick doughs, such as bread's and pizza's dough, egg pasta, etc.
- Always use both dough hooks.

### Wire beaters (9)

- Use this accessory for creams with little consistency, sauces, mayonnaise, to beat cream, eggs, liquids, egg whites, etc.
- Always use both beaters.



Make sure that the bowl used is sufficiently large and high, as well as positioned on a stable surface.

### USE (Fig. A)

- Insert the plug into the power outlet, display (4) off.
- Press the button to activate the **Stand-by mode**: the display (4a) shows 0 and the display (4b) shows 00, all of them flashing.



After 30 seconds of non-use, the display turns off.

- From **Stand-by mode** press the buttons / to start the motor and increase or decrease the speed, display (4b) will count up from 01 seconds to 59 seconds while the display (4a) shows the selected speed.
- After 1 minute of operation the display (4b) return to 0 and the first segment of the minutes running line light up to indicate that 1 minute is passed. The same for second minute and so up to 4 minutes and 59 seconds. After this time:
  - The motor automatically stops.
  - Display (4a) shows 0.
  - Display (4b) shows 4m59s blinking.
- When motor is running, press button to return in **Stand-by mode**.
- Pressing the button a second time turns the mixer off.



### Smooth Start system

At the start of the appliance, speed increases progressively until the set speed is reached. This prevents the appliance and the tools from damaging and the ingredients from escaping from the container used.

### Turbo function

- Keeping pressed button for 1 second will be activated **TURBO function**: display (4a) will show 9 number, display (4b) will continue the seconds count up. The motor speed will be the maximum allowed.
- After releasing the button the motor speed come back to original set one shown on display (4a). The display (4b) continues the seconds count up.
- When motor is running, press button to return in **Stand-by mode**.



## Hints and tips

### ADVICES

- Activate the appliance at a low speed until the ingredients are mixed and then increase the speed according to the operation to be performed.
- Climatic conditions, seasonal temperature differences, temperature and consistency of the ingredients could affect the preparation time necessary as well as the results.
- For the best results with thick dough, work it with rotational movements and check that the liquid ingredients are at least 50% of the total dough.



To work thick dough, do not exceed a maximum of 500 g of flour and let the mixer cool for about 5 minutes before reusing. Switch it off as soon as you've got the right consistency.



Place the container to be used for the processing on a stable and flat surface.



During processing or when not in use, it is possible to position the appliance on the specific feet (1 1) (Fig.C).







To protect your handmixer it is fitted with a protection device which will stop the handmixer operating if overloaded. If activated, the flashing symbol  will appear on the display; switch off, unplug, wait 10 minutes and then plug back into the power supply.

### RECOMMENDED SPEEDS

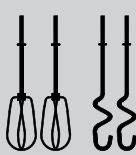

Please note that these are recommendations only and the speed you select may depend upon the bowl size, quantities, the ingredients you are mixing and personal preference.

Speed	Function	Accessory
Low 1 - 3	<u>Combine</u> Combining ingredients	
Low 1 - 3	<u>Knead</u> Kneading leavened doughs (bread, pizza)	
Medium 4 - 6	<u>Mixing</u> Mixing and beating liquid batters. Mixing compounds with eggs, butter such as cake mixes	
High 7 - 9	<u>Whipping and whisking</u> Whisking light or dense batters. Whipping cream, egg whites or sauce.	



To mix leavened dough, use only the dough hooks.



## CLEANING AND MAINTENANCE (Fig. C)



Before carrying out any cleaning operation, ALWAYS disconnect the plug from the power outlet and allow the appliance to cool down. Never immerse the motor base (1) in water or other liquids.

The instruction manual contains appropriate instructions for cleaning and maintenance operations and operations recommended to the customer by the producer. Any other intervention must be performed by a representative of an authorised service centre.

- Pull the accessory release trigger (3) upwards and remove the accessories.
- Beaters, dough hooks, wire beaters accessories are dishwasher safe.
- Dry all parts of the appliance after cleaning.
- The motor base can be cleaned by first using a damp cloth and then a dry one. Do not use detergents or abrasive materials.

## What To Do If.....

<b>Problem</b>	<b>Possible causes</b>	<b>Solution</b>
The motor works at a lower speed than the set one.	The dough in the bowl is too thick.	Remove part of it to lighten it.
The motor will not start.	The plug has not been inserted.	Insert the plug.
	The product has not been activated.	Activate the product by pressing the ON/OFF button.
The whisks stop rotating and the flashing symbol <b>— —</b> appears on the display.	The motor is damaged.	Contact the service centre.
	The product is equipped with a protection device that interrupts the operation of the motor in case of overload.	To reset it, turn off the appliance, unplug the product and let it cool for at least 10 minutes. Then reconnect the power supply to the socket.
The accessories do not fit into their seat.	The place of insertion of the accessory is not the correct one.	Respect the shape of the accessory by coupling it with its seat.



If the problem cannot be solved or for other types of faults, contact the local after-sales service.



The manufacturer reserves the right to make any changes deemed useful for the improvement of its products without prior notice. The illustrations and descriptions contained in this manual are therefore not binding and are merely indicative.

Le fabricant se réserve la faculté d'apporter, sans préavis, toutes les modifications qu'il jugera utiles pour l'amélioration de ses produits. Les illustrations et les descriptions figurant dans ce manuel ne sont pas contraignantes et n'ont qu'une valeur indicative.

El fabricante se reserva el derecho a aportar sin aviso previo todas las modificaciones que considere útiles para la mejora de sus propios productos. Las ilustraciones y las descripciones contenidas en este manual no comprometen, por tanto, al fabricante y tienen un valor meramente indicativo.