

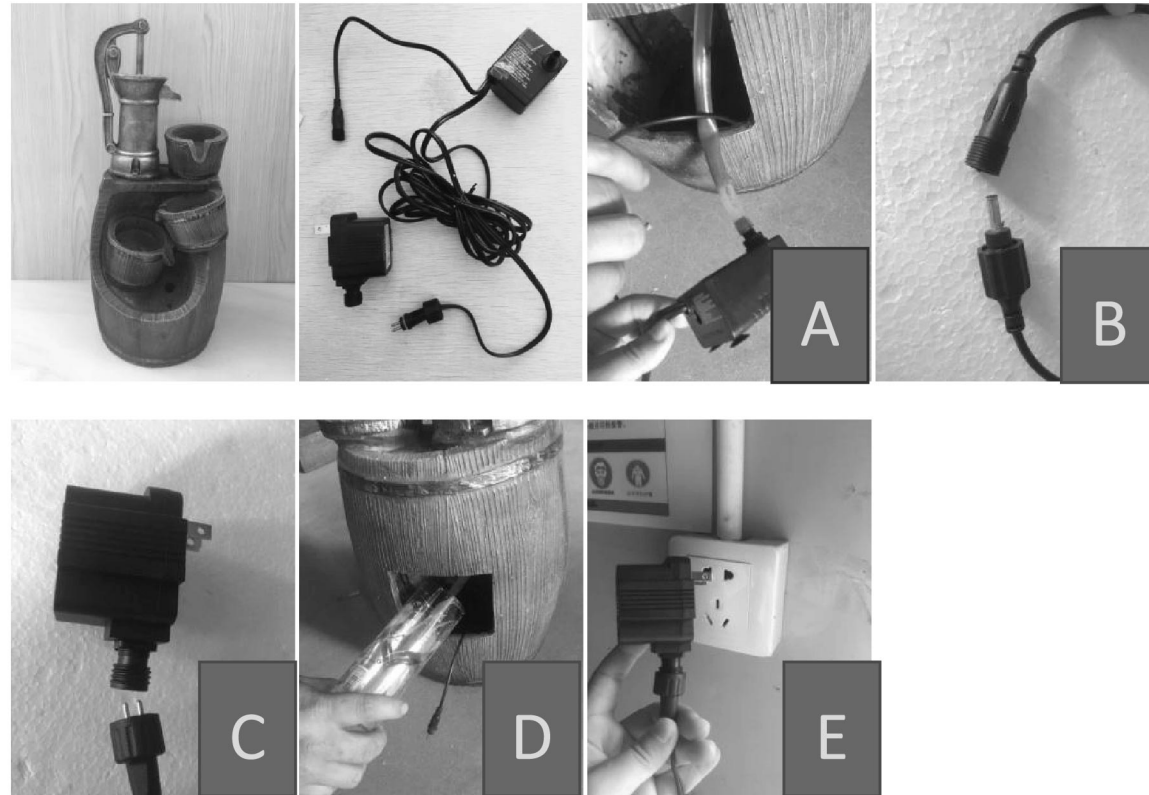

OUTDOOR WATER FOUNTAIN TIERED BARRELS WITH LED LIGHTS



ASSEMBLY INSTRUCTIONS:

STEP 1- UNPACK THE PRODUCT. READ THIS INSTRUCTION SHEET BEFORE PROCEEDING. DISCARD PACKING. KEEP PLASTIC BAG AWAY FROM CHILDREN.

STEP 2 - POSITION STATUE PORTION OF FOUNTAIN ON AN EVEN SURFACE.

STEP 3 - TAKE THE PLASTIC TUBE AND LED LIGHT CONNECTING CORD OUT OF THE PRODUCT. CONNECT THE PLASTIC TUBE FROM THE FOUNTAIN TO THE BLACK TUBE ON THE BLACK PUMP (A). CONNECT THE LED CONNECTING CORD FROM THE FOUNTAIN WITH THE LED CORD ON THE PUMP (B). CONNECT THE PUMP WITH THE TRANSFORMER PLUG (C).

STEP 4 - PUT THE PUMP AND LED LIGHT CORD INSIDE BASE. KEEPING THE PLUG OUTSIDE THE

FOUNTAIN. THEN USING A WATER BOTTLE (D) FILL WITH DISTILLED WATER. THROUGH THE HOLE IN THE BACK OF THE FOUNTAIN. (D) USING DISTILLED WATER WILL REDUCE MINERAL BUILD UP IN YOUR FOUNTAIN AND PROLONG THE LIFE OF THE PUMP.

STEP 5 - ENSURE THE PUMP IS COMPLETELY SUBMERGED IN DISTILLED WATER. BE CAREFUL TO AVOID WATER OVERFLOW. REMOVE THE POWER CABLE FROM THE BACK OF THE FOUNTAIN.

STEP 6 -ENSURE THE MAIN OUTLET/PLUG SITS HIGHER THAN THE PUMP SO THAT IF ANY WATER SPILL FROM THE BACK IT WILL NOT FLOW INTO THE MAIN OUTLET/PLUG.

STEP 7 - ONCE FOUNTAIN IS ASSEMBLED, INSERT PLUG INTO PROPER OUTLET. (E) WATER MAY TAKE A SHORT TIME TO BEGIN FLOWING AS AIR CLEARS FROM THE PUMP TO THE HOSE. WATER FLOW IS ADJUSTABLE BY LEVER ON SIDE OF THE PUMP.

BE SURE TO DISCONNECT FROM THE MAIN OUTLET BEFORE MAKING ANY FOUNTAIN ADJUSTMENTS

WARNINGS:

- FOR OUTDOOR USE ONLY.
- CHECK FOR LEAKS & SPLASHING AFTER INITIAL SET-UP.
- DO NOT LEAVE FOUNTAIN RUNNING FOR LONG PERIODS OF TIME AND NEVER UNATTENDED.
- CHECK THE AREA AROUND FOUNTAIN REGULARLY TO ENSURE NO LEAKAGE.

MAINTENANCE:

- KEEP WATER CLEAN TO REDUCE MINERAL BUILD-UP, CLEAN PERIODICALLY.
- ADD WATER PERIODICALLY TO ENSURE PUMP STAYS FULLY SUBMERGED.
- DISCONNECT THE POWER & EMPTY BASIN IF THE FOUNTAIN WILL NOT BE IN USE FOR AN EXTENDED TIME.
- DO NOT LEAVE OUT IN EXTREME OR BELOW FREEZING TEMPERATURES. THIS WILL CAUSE WATER TO FREEZE AND DAMAGE THE UNIT.