

FEATURES

- Classic stainless steel designed to match Wolf E series ovens.
- Can be installed in a standard or flush inset (accessory required) application.
- 20% larger interior capacity accommodates 9" x 13" pans and cups up to 7" in height.
- 10 power levels and sensor cooking make cooking easy.
- Keep warm setting allows food to be kept warm for up to 99 minutes.
- Kitchen timer can be set for up to 99 minutes and 99 seconds.
- Control panel lock can be locked for child safety or to prevent unwanted use.



MODEL OPTIONS

DRAWER MICROWAVE

Transitional

MD24TE/S

ACCESSORIES

- Flush inset vent.

Accessories available through an authorized Wolf dealer. For local dealer information, visit the find a showroom section of our website, wolfappliance.com.

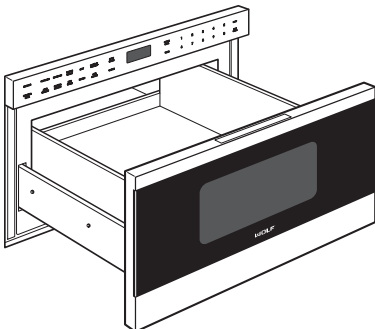

SPECIFICATIONS

PRODUCT

Dimensions 23⁵/₈"W x 15¹/₈"H x 21⁷/₈"D
 Weight 91 lb

OVEN INTERIOR

Capacity 1.2 cu ft
 Dimensions 17⁵/₁₆"W x 7¹/₈"H x 16⁹/₁₆"D

ELECTRICAL

Power 950 W
 Supply 120 VAC, 60 Hz
 Service 15 amp circuit
 Power Cord 4 ft

DIMENSIONS

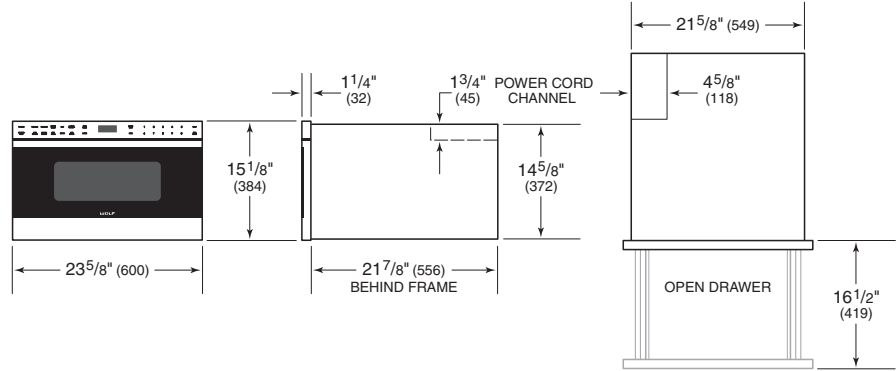

Specifications are subject to change without notice. Visit wolfappliance.com/specs for the most up-to-date information.

Dimensions may vary $\pm 1/8$ " (3). Dimensions in parentheses are millimeters unless otherwise specified.

STANDARD INSTALLATION

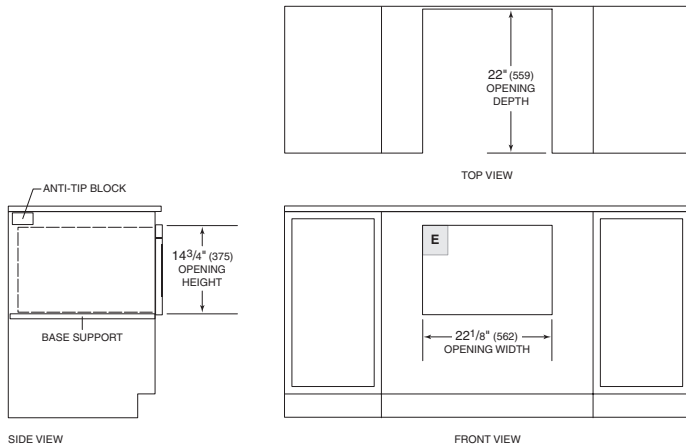

NOTE: All drawer microwave ovens require the same opening dimensions. Dashed line represents profile of unit.

FLUSH INSET INSTALLATION

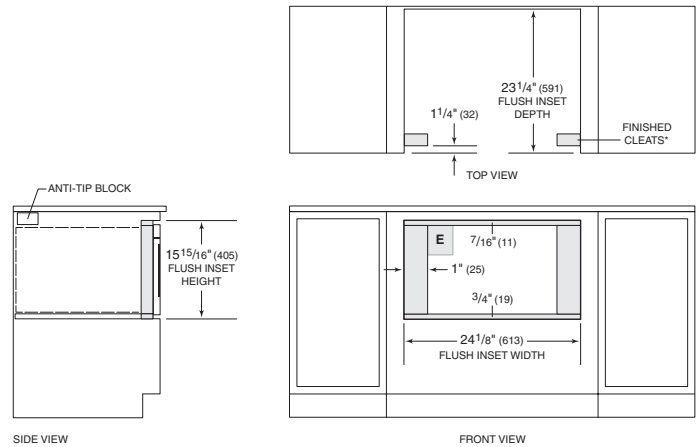

*Will be visible and should be finished to match cabinetry. NOTE: Dashed line represents profile of unit.