

This quick reference guide to refrigeration accessories will help to make sure you have what you need for a successful installation in just 3 easy steps.

Step 1 Find your model number in this guide. Model numbers that contain an underscore (_) are available in multiple colors. For example, LRMVC2306_ comes in both PrintProof® Stainless Steel (LRMVC2306S) and in PrintProof® Black Stainless Steel (LRMVC2306D). SRFVC2416S does not have the underscore as it only comes in PrintProof® Stainless Steel. Be sure to confirm availability and ordering of your color of choice.

Step 2 Read the information on required and optional accessories to determine your needs and prepare yourself by knowing the answers to the following questions.

- If purchasing a refrigerator with a dispenser and / or an automatic ice maker, do you have a cold water supply at the installation location?
- Do you have a reverse osmosis water filter system connected to your cold water supply?
- Do you have a grounded 3-prong electrical outlet within 6 ft. and a min. 15 Amp circuit?
- If purchasing a Top or Bottom Freezer Refrigerator, do you need to reverse the doors?

Step 3 Identify the items you need to purchase for your refrigerator. Items with a check box need to be purchased separately.

Where to Buy?

Required Accessories

Purchase from dealer links, in-store with unit purchase, or if part is available, click the LG parts & accessories button.*

Optional Accessories

Purchase by clicking the LG parts & accessories button* or call 1-800-243-0000.

LG Parts & Accessories

Contents

- 36" Wide French Door InstaView® Ice & Water Dispensing 2**
- 36" & 33" Wide French Door Ice & Water Dispensing 3**
- 36"-33" & 30" Wide French Door Non-Ice Dispensing 4**
- Side-by-Side 5**
- Top Freezer 6**
- Bottom Freezer 7**
- Specialty 8**





ACCESSORY GUIDE: 36" WIDE FRENCH DOOR INSTAVIEW® REFRIGERATORS

What Accessories Do I Need to Purchase for My LG 36" Wide French Door InstaView® Ice & Water Dispensing Refrigerator?

Items in RED with a check box require you to make a purchase

Items in BLACK with a check box are optional

Items in BLACK without a box are included with purchase.

STEP 1: FIND YOUR MODEL NUMBER

SRFVC2416S, LRMVS3006S, LRMVC2306_(S, D), LRYKS3106_(S, D), LRYKC2606_(S, D), LMXS28596_(S, D), LRFOC2606S



STEP 2: READ THIS INFORMATION

Required Accessories Purchase from dealer links, in-store with unit purchase, or if part is available, click the LG parts & accessories button† or call 1-800-243-0000. LG Parts & Accessories	Water Supply Requirements: LG refrigerators must be connected to a cold water supply for operation of the water dispenser and / or automatic icemaker. Required min. / max. water pressure is 20–120 psi.*	
	Compression nuts and ferrules are used to connect the copper tubing to the shutoff valve and the refrigerator water valve.	
	Shutoff valve to connect to the cold water line. A shutoff valve should have a water inlet with a minimum inside diameter of 5/32" at the point of connection to the cold water line.**	
Optional Accessories Purchase by clicking the LG parts & accessories button† or call 1-800-243-0000. LG Parts & Accessories	Electrical Requirements: LG refrigerators have a 3-prong power cord attached to the unit. A grounded outlet located within 6 ft. of the unit and a min. 15 Amp circuit is required.	
	Water Filter: Select LG refrigerators include 1 water filter. It is recommended to change the air filter every 200 gallons or approximately every 6 months. Order an extra filter now to keep on-hand.	
	Fresh Air Filter: Select LG refrigerators include 1 fresh air filter. It is recommended to change the air filter approximately every 6 months. Order an extra filter now to keep on-hand.	

STEP 3: IDENTIFY THE ITEMS YOU NEED TO PURCHASE FOR YOUR MODEL NUMBER

<input type="checkbox"/> 1/4" Outer Diameter Copper or PEX Tubing
<input type="checkbox"/> Two 1/4" Outer Diameter Compression Nuts and Two Ferrules (Sleeves)
<input type="checkbox"/> Water Shutoff Valve
3-Prong Power Cord Attached to Unit
<input type="checkbox"/> LT1000P Replacement Water Filter (built-in water filter bypass)
<input type="checkbox"/> LT120F Replacement Fresh Air Filter

⊗ S – PrintProof® Stainless Steel □ S – Stainless Steel ⊗ D – PrintProof® Black Stainless Steel ▲ V – Stainless Look ○ W – White ● B – Black

*40–60 psi min. when a reverse osmosis water filtration system is connected to the cold water supply. **Saddle-type shutoff valves are included in many water supply kits. Before purchasing, make sure a saddle-type valve complies with your local plumbing codes.



ACCESSORY GUIDE: 36" & 33" WIDE FRENCH DOOR ICE DISPENSING REFRIGERATORS

What Accessories Do I Need to Purchase for My LG 36" & 33" Wide French Door Ice & Water Dispensing Refrigerator?

- Items in RED with a check box require you to make a purchase
- Items in BLACK with a check box are optional
- Items in BLACK without a box are included with purchase.

STEP 1: FIND YOUR MODEL NUMBER

LRMDS3006_(S, D), LRMD2306S, LF29S8330_(S, D), LF29H8330_(S, D), LMXS28626_(S, D), LMXC22626S, LRMXC1803S, LRYXS3106_(S, D), LRYXC2606_(S, D), LRFXS3106S, LRFXC2606S, LRF28XB_(S, D), LFXS26973_(S, D), LFXC22526_(S, D), LRFXS2503_(S, D)



STEP 2: READ THIS INFORMATION

Required Accessories
Purchase from dealer links, in-store with unit purchase, or if part is available, click the LG parts & accessories button[†] or call 1-800-243-0000.

LG Parts & Accessories

Water Supply Requirements:
LG refrigerators must be connected to a cold water supply for operation of the water dispenser and / or automatic icemaker. Required min. / max. water pressure is 20–120 psi.*

Compression nuts and ferrules are used to connect the copper tubing to the shutoff valve and the refrigerator water valve.

Shutoff valve to connect to the cold water line. A shutoff valve should have a water inlet with a minimum inside diameter of 5/32" at the point of connection to the cold water line.**

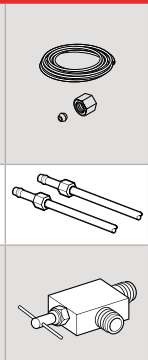

STEP 3: IDENTIFY THE ITEMS YOU NEED TO PURCHASE FOR YOUR MODEL NUMBER

1/4" Outer Diameter Copper or PEX Tubing

Two 1/4" Outer Diameter Compression Nuts and Two Ferrules (Sleeves)

Water Shutoff Valve

Electrical Requirements:
LG refrigerators have a 3-prong power cord attached to the unit. A grounded outlet located within 6 ft. of the unit and a min. 15 Amp circuit is required.

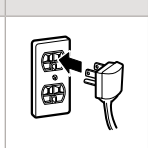

3-Prong Power Cord Attached to Unit

Optional Accessories
Purchase by clicking the LG parts & accessories button[†] or call 1-800-243-0000.

LG Parts & Accessories

Water Filter:
Select LG refrigerators include 1 water filter. It is recommended to change the air filter every 200 gallons or approximately every 6 months. Order an extra filter now to keep on-hand.

Fresh Air Filter:
Select LG refrigerators include 1 fresh air filter. It is recommended to change the air filter approximately every 6 months. Order an extra filter now to keep on-hand.



LT1000P Replacement Water Filter (built-in water filter bypass)

LT120F Replacement Fresh Air Filter

⊙ S – PrintProof® Stainless Steel □ S – Stainless Steel ⊙ D – PrintProof® Black Stainless Steel ▲ V – Stainless Look ○ W – White ● B – Black

*40–60 psi min. when a reverse osmosis water filtration system is connected to the cold water supply. **Saddle-type shutoff valves are included in many water supply kits. Before purchasing, make sure a saddle-type valve complies with your local plumbing codes.



36"-33" & 30" WIDE FRENCH DOOR NON-ICE DISPENSING REFRIGERATORS

ACCESSORY GUIDE:

What Accessories Do I Need to Purchase for My LG 36"-33" & 30" Wide French Door Non-Ice Dispensing Refrigerator?

- Items in RED with a check box require you to make a purchase
- Items in BLACK with a check box are optional
- Items in BLACK without a box are included with purchase.

STEP 1: FIND YOUR MODEL NUMBER											
LF30S8210S, LF30H8210S, LRMWS2906S, LRFWS2906_(V, S, D), LMWS27626S, LFDS22520S, LRFCS29D6S, LF21G6200S, LRFCC23D6S						SRFB27_3(S, W), LRFLS3206S, LMWC23626S, LRFLC2706S			LRFCS25D3S, LRMNC1803S, LFCS22520_(S, D)		

STEP 3: IDENTIFY THE ITEMS YOU NEED TO PURCHASE FOR YOUR MODEL NUMBER

STEP 2: READ THIS INFORMATION			STEP 3: IDENTIFY THE ITEMS YOU NEED TO PURCHASE FOR YOUR MODEL NUMBER		
Required Accessories Purchase from dealer links, in-store with unit purchase, or if part is available, click the LG parts & accessories button† or call 1-800-243-0000. LG Parts & Accessories	Water Supply Requirements: LG refrigerators must be connected to a cold water supply for operation of the water dispenser and / or automatic icemaker. Required min. / max. water pressure is 20–120 psi.* 	<input type="checkbox"/> 1/4" Outer Diameter Copper or PEX Tubing			
	Compression nuts and ferrules are used to connect the copper tubing to the shutoff valve and the refrigerator water valve. 	<input type="checkbox"/> Two 1/4" Outer Diameter Compression Nuts and Two Ferrules (Sleeves)			
	Shutoff valve to connect to the cold water line. A shutoff valve should have a water inlet with a minimum inside diameter of 5/32" at the point of connection to the cold water line.** 	<input type="checkbox"/> Water Shutoff Valve			
	Electrical Requirements: LG refrigerators have a 3-prong power cord attached to the unit. A grounded outlet located within 6 ft. of the unit and a min. 15 Amp circuit is required. 	3-Prong Power Cord Attached to Unit			
Optional Accessories Purchase by clicking the LG parts & accessories button† or call 1-800-243-0000. LG Parts & Accessories	Water Filter: Select LG refrigerators include 1 water filter. It is recommended to change the air filter every 200 gallons or approximately every 6 months. Order an extra filter now to keep on-hand. 	<input type="checkbox"/> LT1000P Replacement Water Filter (built-in water filter bypass)			Not Applicable
	Fresh Air Filter: Select LG refrigerators include 1 fresh air filter. It is recommended to change the air filter approximately every 6 months. Order an extra filter now to keep on-hand. 	Not Applicable	<input type="checkbox"/> LT120F Replacement Fresh Air Filter		

● S – PrintProof® Stainless Steel □ S – Stainless Steel ● D – PrintProof® Black Stainless Steel ▲ V – Stainless Look ○ W – Essence White ○ W – White ● B – Black

*40–60 psi min. when a reverse osmosis water filtration system is connected to the cold water supply. **Saddle-type shutoff valves are included in many water supply kits. Before purchasing, make sure a saddle-type valve complies with your local plumbing codes.

What Accessories Do I Need to Purchase for My LG Side-by-Side Refrigerator?

- Items in RED with a check box require you to make a purchase
- Items in BLACK with a check box are optional
- Items in BLACK without a box are included with purchase.

STEP 2: READ THIS INFORMATION

Required Accessories Purchase from dealer links, in-store with unit purchase, or if part is available, click the LG parts & accessories button† or call 1-800-243-0000. LG Parts & Accessories	Water Supply Requirements: LG refrigerators must be connected to a cold water supply for operation of the water dispenser and / or automatic icemaker. Required min. / max. water pressure is 20–120 psi.*	
	Compression nuts and ferrules are used to connect the copper tubing to the shutoff valve and the refrigerator water valve.	
	Shutoff valve to connect to the cold water line. A shutoff valve should have a water inlet with a minimum inside diameter of 5/32" at the point of connection to the cold water line.**	
	Electrical Requirements: LG refrigerators have a 3-prong power cord attached to the unit. A grounded outlet located within 6 ft. of the unit and a min. 15 Amp circuit is required.	

Optional Accessories Purchase by clicking the LG parts & accessories button† or call 1-800-243-0000. LG Parts & Accessories	Water Filter: Select LG refrigerators include 1 water filter. It is recommended to change the air filter every 200 gallons or approximately every 6 months. Order an extra filter now to keep on-hand.	
	Water Filter Bypass: Attaches in the water filter head and allows the water to flow to the dispenser and/or ice maker when the filter has been removed.	
	Fresh Air Filter: Select LG refrigerators include 1 fresh air filter. It is recommended to change the air filter approximately every 6 months. Order an extra filter now to keep on-hand.	

STEP 1: FIND YOUR MODEL NUMBER

SRSXB2622S 	LRSOS2706_(S, D), LRSDS2706S, LRSWS2806S, LRSXS2706_(S, V, W, B), LRSXC2306S
----------------	--

STEP 3: IDENTIFY THE ITEMS YOU NEED TO PURCHASE FOR YOUR MODEL NUMBER

<input type="checkbox"/> 1/4" Outer Diameter Copper or PEX Tubing		
<input type="checkbox"/> Two 1/4" Outer Diameter Compression Nuts and Two Ferrules (Sleeves)		
<input type="checkbox"/> Water Shutoff Valve		
3-Prong Power Cord Attached to Unit		
<input type="checkbox"/> LT700P Replacement Water Filter	<input type="checkbox"/> LT1000P Replacement Water Filter (built-in water filter bypass)	
<input type="checkbox"/> ABN73019101	Not Applicable	
<input type="checkbox"/> LT120F Replacement Fresh Air Filter	Not Applicable	

S – PrintProof® Stainless Steel
 S – Stainless Steel
 D – PrintProof® Black Stainless Steel
 V – Stainless Look
 W – White
 B – Black

*40–60 psi min. when a reverse osmosis water filtration system is connected to the cold water supply. **Saddle-type shutoff valves are included in many water supply kits. Before purchasing, make sure a saddle-type valve complies with your local plumbing codes.

What Accessories Do I Need to Purchase for My LG Top Freezer Refrigerator?

Items in RED with a check box require you to make a purchase

Items in BLACK with a check box are optional

Items in BLACK without a box are included with purchase.

STEP 2: READ THIS INFORMATION

Required Accessories Purchase from dealer links, in-store with unit purchase, or if part is available, click the LG parts & accessories button [†] or call 1-800-243-0000. LG Parts & Accessories	Water Supply Requirements: LG refrigerators must be connected to a cold water supply for operation of the water dispenser and / or automatic icemaker. Required min. / max. water pressure is 20–120 psi.*	
	Compression nuts and ferrules are used to connect the copper tubing to the shutoff valve and the refrigerator water valve.	
	Shutoff valve to connect to the cold water line. A shutoff valve should have a water inlet with a minimum inside diameter of 5/32" at the point of connection to the cold water line.**	
	Electrical Requirements: LG refrigerators have a 3-prong power cord attached to the unit. A grounded outlet located within 6 ft. of the unit and a min. 15 Amp circuit is required.	

Optional Accessories Purchase by clicking the LG parts & accessories button [†] or call 1-800-243-0000. LG Parts & Accessories	Optional Ice Maker	
	Water Filter: Select LG refrigerators include 1 water filter. It is recommended to change the air filter every 200 gallons or approximately every 6 months. Order an extra filter now to keep on-hand.	
	Water Filter Bypass: Attaches in the water filter head and allows the water to flow to the dispenser and/or ice maker when the filter has been removed.	

STEP 1: FIND YOUR MODEL NUMBER

LTCS20030S	LRTLS2403S	LTCS20020_(S, W, B)	LT11C2000V

STEP 3: IDENTIFY THE ITEMS YOU NEED TO PURCHASE FOR YOUR MODEL NUMBER

<input type="checkbox"/> 1/4" Outer Diameter Copper or PEX Tubing	Required only if purchasing the optional ice maker.	Not required
<input type="checkbox"/> Two 1/4" Outer Diameter Compression Nuts and Two Ferrules (Sleeves)	Required only if purchasing the optional ice maker.	Not required
<input type="checkbox"/> Water Shutoff Valve	Required only if purchasing the optional ice maker.	Not required
3-Prong Power Cord Attached to Unit		
Not Required. This Model has a factory-installed ice maker.	<input type="checkbox"/> LK75C Optional Ice Maker	<input type="checkbox"/> LK65C Optional Ice Maker Not Applicable
Not Applicable	<input type="checkbox"/> LT500P Replacement Water Filter	Not Applicable
Not Applicable	<input type="checkbox"/> ABN75058701	Not Applicable

S – PrintProof® Stainless Steel
 S – Stainless Steel
 D – PrintProof® Black Stainless Steel
 V – Stainless Look
 W – White
 B – Black

*40–60 psi min. when a reverse osmosis water filtration system is connected to the cold water supply. **Saddle-type shutoff valves are included in many water supply kits. Before purchasing, make sure a saddle-type valve complies with your local plumbing codes.

What Accessories Do I Need to Purchase for My LG Bottom Freezer Refrigerator?

Items in RED with a check box require you to make a purchase

Items in BLACK with a check box are optional

Items in BLACK without a box are included with purchase.

STEP 2: READ THIS INFORMATION

STEP 2: READ THIS INFORMATION		STEP 3: IDENTIFY THE ITEMS YOU NEED TO PURCHASE FOR YOUR MODEL NUMBER		
Required Accessories Purchase from dealer links, in-store with unit purchase, or if part is available, click the LG parts & accessories button† or call 1-800-243-0000. LG Parts & Accessories	Water Supply Requirements: LG refrigerators must be connected to a cold water supply for operation of the water dispenser and / or automatic icemaker. Required min. / max. water pressure is 20–120 psi.*		<input type="checkbox"/> 1/4" Outer Diameter Copper or PEX Tubing	Not required
	Compression nuts and ferrules are used to connect the copper tubing to the shutoff valve and the refrigerator water valve.		<input type="checkbox"/> Two 1/4" Outer Diameter Compression Nuts and Two Ferrules (Sleeves)	Not required
	Shutoff valve to connect to the cold water line. A shutoff valve should have a water inlet with a minimum inside diameter of 5/32" at the point of connection to the cold water line.**		<input type="checkbox"/> Water Shutoff Valve	Not required
	Electrical Requirements: LG refrigerators have a 3-prong power cord attached to the unit. A grounded outlet located within 6 ft. of the unit and a min. 15 Amp circuit is required.		3-Prong Power Cord Attached to Unit	
Optional Accessories Purchase by clicking the LG parts & accessories button† or call 1-800-243-0000. LG Parts & Accessories	Water Filter: Select LG refrigerators include 1 water filter. It is recommended to change the air filter every 200 gallons or approximately every 6 months. Order an extra filter now to keep on-hand.		<input type="checkbox"/> LT1000P Replacement Water Filter (built-in water filter bypass)	Not Applicable

⊗ S – PrintProof® Stainless Steel □ S – Stainless Steel ⊗ D – PrintProof® Black Stainless Steel ▲ V – Stainless Look ○ W – White ● B – Black

*40–60 psi min. when a reverse osmosis water filtration system is connected to the cold water supply. **Saddle-type shutoff valves are included in many water supply kits. Before purchasing, make sure a saddle-type valve complies with your local plumbing codes.

STEP 1: FIND YOUR MODEL NUMBER		
LRDCS2603_(S, D)	LRBCC1204S	LBNC15231V, LRBNC1104S

What Accessories Do I Need to Purchase for My LG Specialty Refrigerator?

- Items in RED with a check box require you to make a purchase
- Items in BLACK with a check box are optional
- Items in BLACK without a box are included with purchase.

STEP 2: READ THIS INFORMATION

Required Accessories Purchase from dealer links, in-store with unit purchase, or if part is available, click the LG parts & accessories button† or call 1-800-243-0000. LG Parts & Accessories	Water Supply Requirements: LG refrigerators must be connected to a cold water supply for operation of the water dispenser and / or automatic icemaker. Required min. / max. water pressure is 20–120 psi.*	
	Compression nuts and ferrules are used to connect the copper tubing to the shutoff valve and the refrigerator water valve.	
	Shutoff valve to connect to the cold water line. A shutoff valve should have a water inlet with a minimum inside diameter of 5/32" at the point of connection to the cold water line.**	
	Electrical Requirements: LG refrigerators have a 3-prong power cord attached to the unit. A grounded outlet located within 6 ft. of the unit and a min. 15 Amp circuit is required.	
Optional Accessories Purchase by clicking the LG parts & accessories button† or call 1-800-243-0000. LG Parts & Accessories	Water Filter: Select LG refrigerators include 1 water filter. It is recommended to change the air filter every 200 gallons or approximately every 6 months. Order an extra filter now to keep on-hand.	

STEP 1: FIND YOUR MODEL NUMBER

LRKNS1400V, LRONC0705A, LROFC0605V, LRONC0605V

STEP 3: IDENTIFY THE ITEMS YOU NEED TO PURCHASE FOR YOUR MODEL NUMBER

Not required
Not required
Not required
3-Prong Power Cord Attached to Unit
Not Applicable

S – PrintProof® Stainless Steel
 S – Stainless Steel
 D – PrintProof® Black Stainless Steel
 V – Stainless Look
 W – White
 B – Black

*40–60 psi min. when a reverse osmosis water filtration system is connected to the cold water supply. **Saddle-type shutoff valves are included in many water supply kits. Before purchasing, make sure a saddle-type valve complies with your local plumbing codes.