

LUCIA SIDE CHAIR ASSEMBLY INSTRUCTIONS

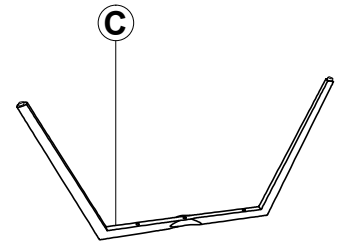

PARTS PACKING CONFIGURATION

- A. SEAT 1 PC
- B. LEG B 1 PC
- C. LEG C 1 PC

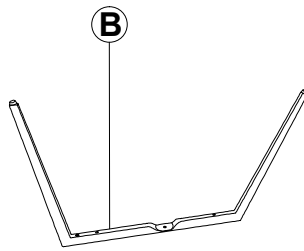
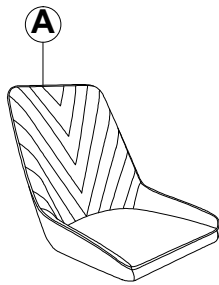

HARDWARE ENCLOSED IN CARTON

No	Description	Photo	Quantity
1	FLAT WASHER (1/4")		5 PCS
2	SPRING WASHER (1/4")		5 PCS
3	ALLEN BOLT (1/4"X1-9/16")		4 PCS
4	ALLEN KEY		1 PC
5	ALLEN BOLT (1/4"X1")		1 PC

LUCIA SIDE CHAIR

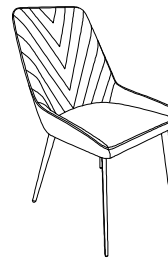

STEP 1:

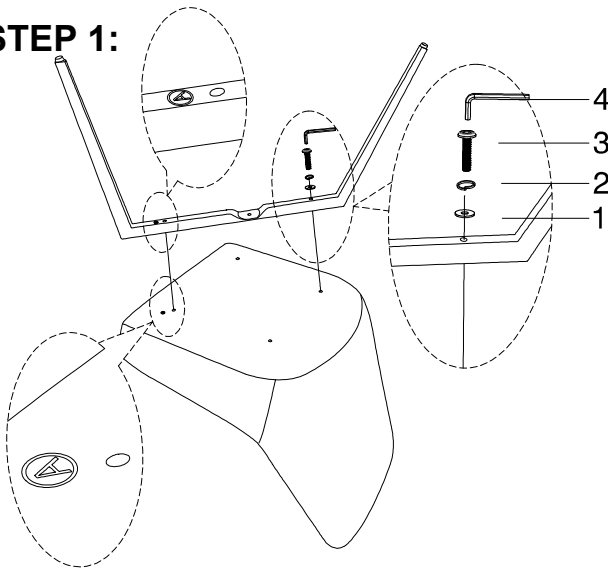

DO NOT TIGHTEN BOLTS COMPLETELY

STEP 2:

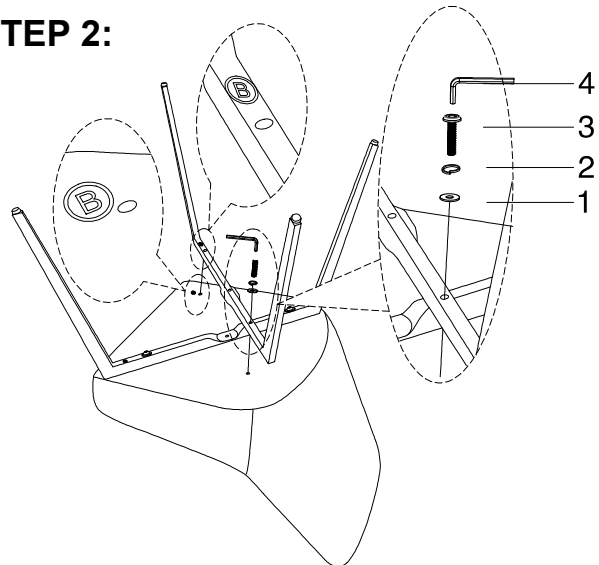

DO NOT TIGHTEN BOLTS COMPLETELY

STEP 3:

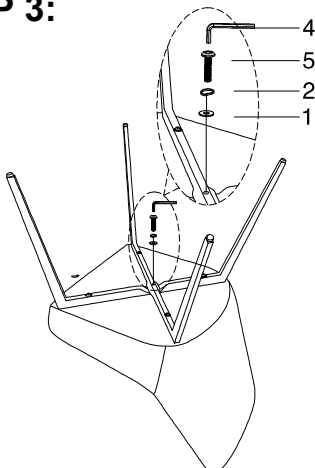

TIGHTEN ALL ASSEMBLY BOLTS

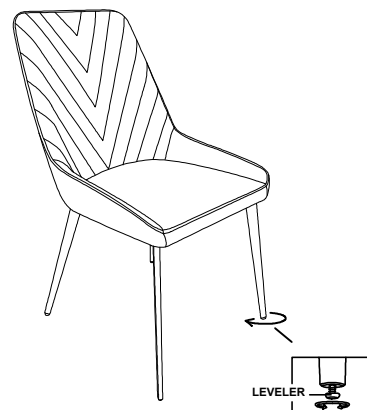

FULLY ASSEMBLED